

**NORTHAMPTON
ROUTE 9**

STATE	FED. AID PROJ. NO.	SHEET NO.	TOTAL SHEETS
MA	70	229	
PROJECT FILE NO. 606286			

STREETSCAPE PLANS

SITE FEATURES		
DESCRIPTION	CALL OUT	QTY ON THIS SHEET
BENCH: 6' L	BE	7
CHAIR	CH	17
TABLE	TA	12
SEATWALL 1: 3' RAD, 4' L	SW1	1
SEATWALL 2: 12' RAD, 6' L	SW2	3
SEATWALL 3: 12' RAD, 15' L	SW3	1
SEATWALL 4: 30' RAD, 10' L	SW4	2
SEATWALL 5: 30' RAD, 12' L	SW5	1
SEATWALL 6: 30' RAD, 15' L	SW6	2
SEATWALL 7: 30' RAD, 16' L	SW7	3
BICYCLE PARKING POSTS	BP	8
TRASH RECEPTACLE	TR	2
RECYCLING RECEPTACLE	RR	2
NEWSPAPER BOX	NB	1
MAILBOX (RESET)	MB	1
WOOD PLATFORM 1: 12'X12'	WP1	2
WOOD PLATFORM 2: 24'X48'	WP2	2
WOOD PLATFORM 3: 6'X6'	WP3	2
SEATING AREA TYPE A	SAA#	6
SEATING AREA TYPE B	SAB#	2
SEATING AREA TYPE C	SAC#	3
BIORETENTION AREA	BA#	1

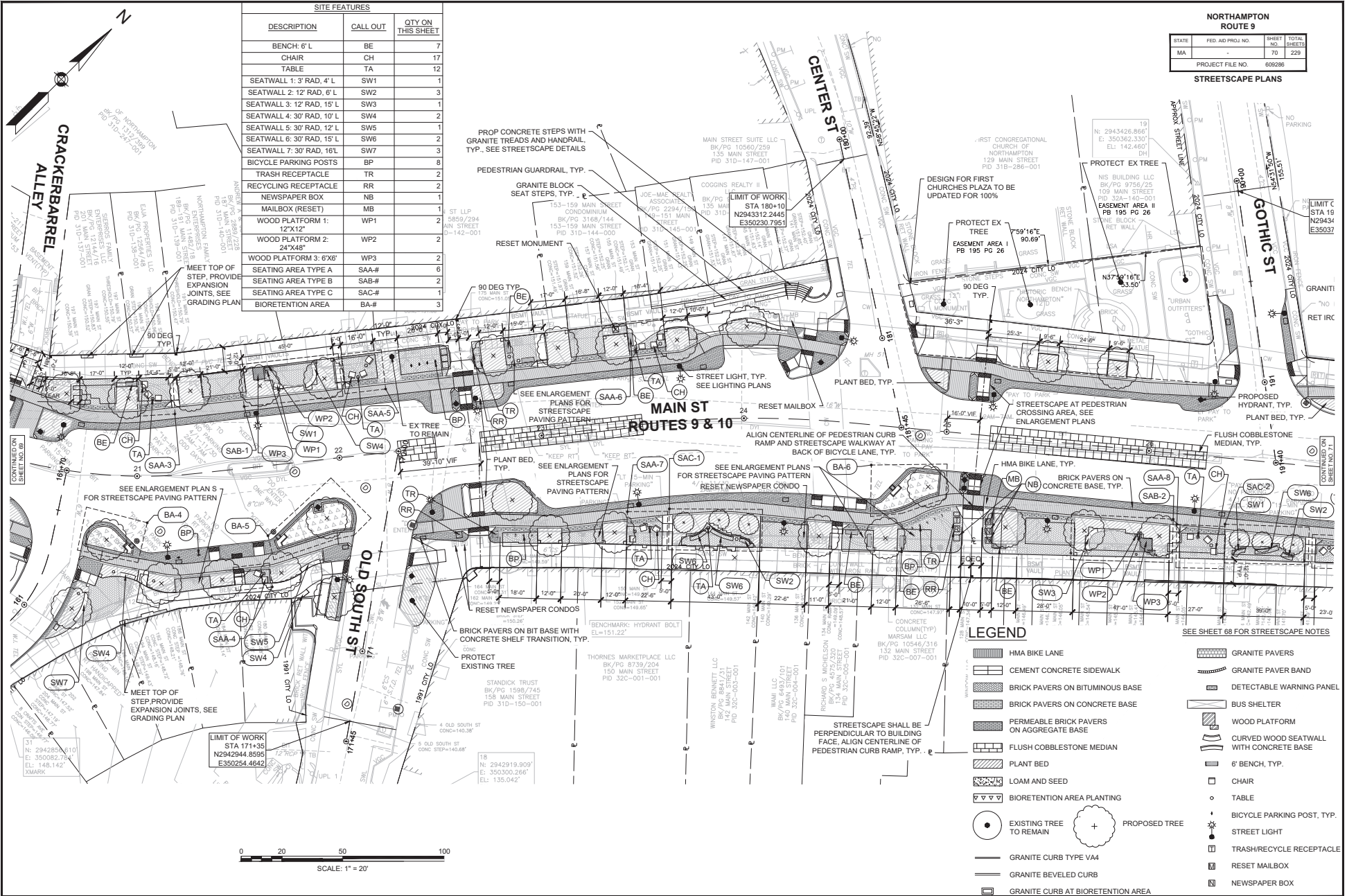

LEGEND

- HMA BIKE LANE
- CEMENT CONCRETE SIDEWALK
- BRICK PAVERS ON BITUMINOUS BASE
- BRICK PAVERS ON CONCRETE BASE
- PERMEABLE BRICK PAVERS ON AGGREGATE BASE
- FLUSH COBBLESTONE MEDIAN
- PLANT BED
- LOAM AND SEED
- BIORETENTION AREA PLANTING
- EXISTING TREE TO REMAIN
- GRANITE CURB TYPE VA4
- GRANITE BEVELED CURB
- GRANITE CURB AT BIORETENTION AREA
- GRANITE PAVERS
- GRANITE PAVER BAND
- DETECTABLE WARNING PANEL
- BUS SHELTER
- WOOD PLATFORM
- CURVED WOOD SEATWALL WITH CONCRETE BASE
- 6' BENCH, TYP.
- CHAIR
- TABLE
- BICYCLE PARKING POST, TYP.
- STREET LIGHT
- TRASH/RECYCLE RECEPTACLE
- RESET MAILBOX
- NEWSPAPER BOX

SEE SHEET 68 FOR STREETSCAPE NOTES

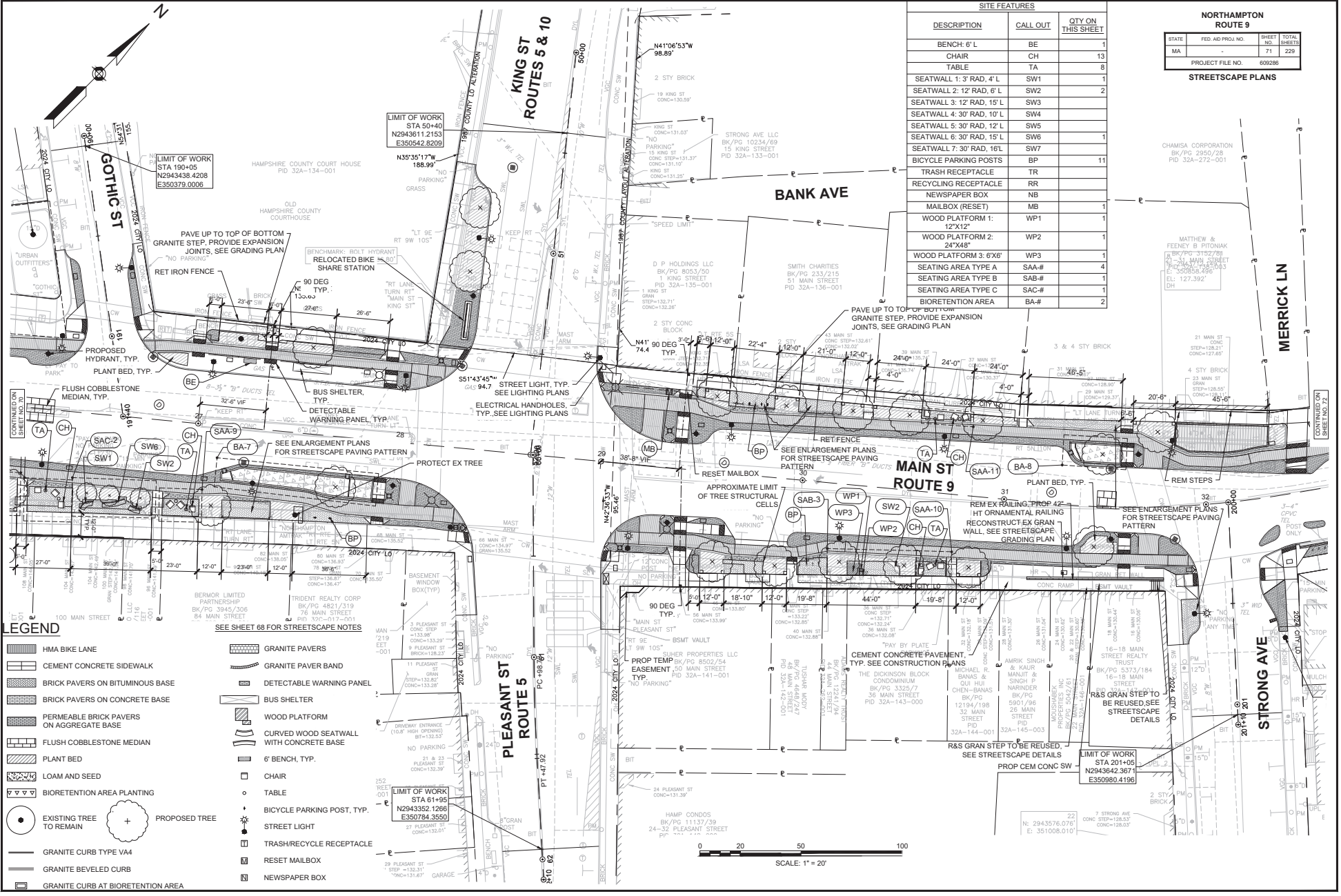

**NORTHAMPTON
ROUTE 9**

STATE	FED. AID PROJ. NO.	SHEET NO.	TOTAL SHEETS
MA		84	229
PROJECT FILE NO. 609286			

TRAFFIC SIGNS & PAVEMENT MARKING PLANS

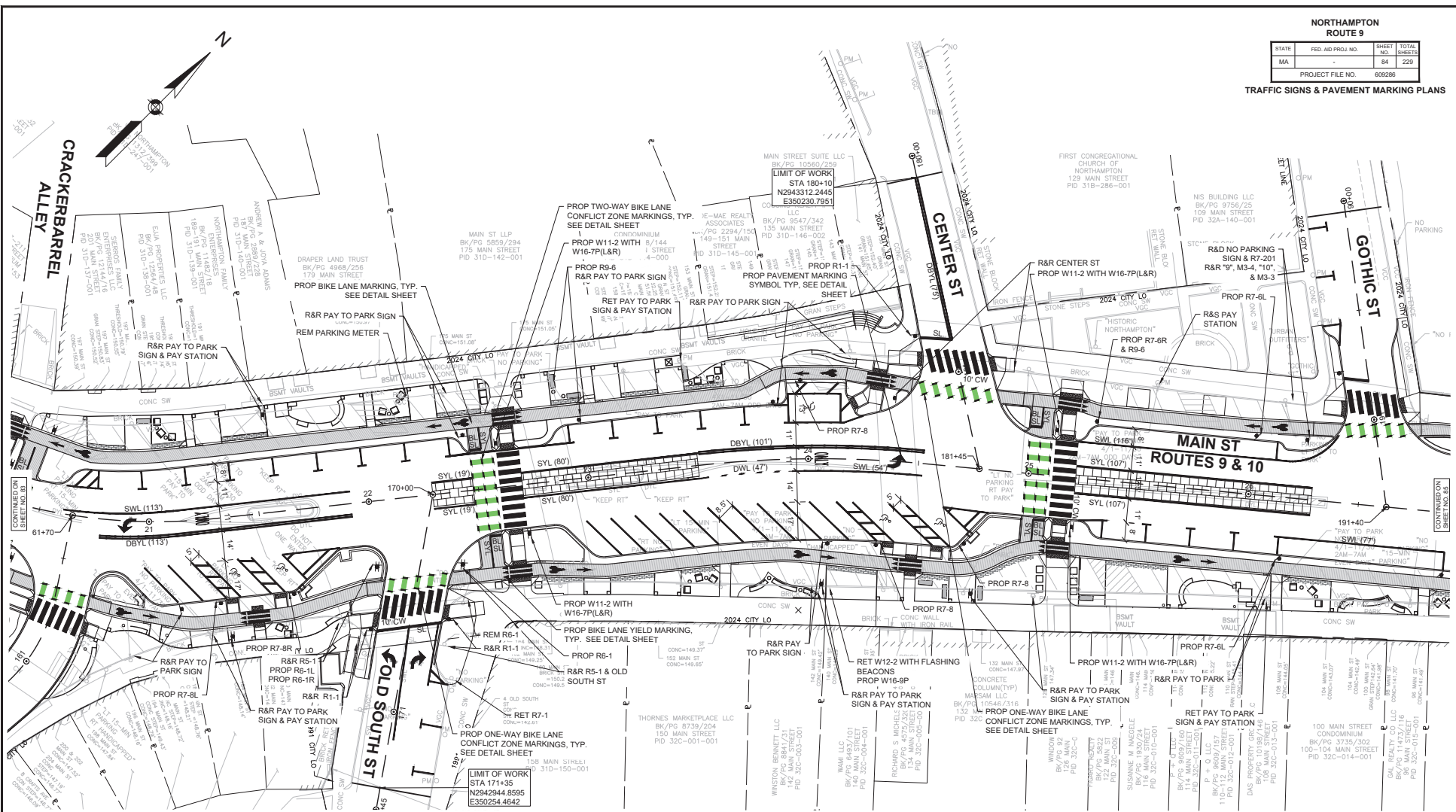

- NOTES:**
1. ALL EXISTING SIGNAGE TO BE REMOVED UNLESS OTHERWISE NOTED.
 2. ALL EXISTING PAVEMENT MARKINGS TO BE REMOVED UNLESS OTHERWISE NOTED.

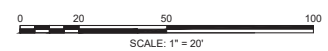

NORTHAMPTON
ROUTE 9

STATE	FED. AID PROJ. NO.	SHEET NO.	TOTAL SHEETS
MA	-	88	229
PROJECT FILE NO. 606286			

TRAFFIC SIGNS & PAVEMENT MARKING PLANS

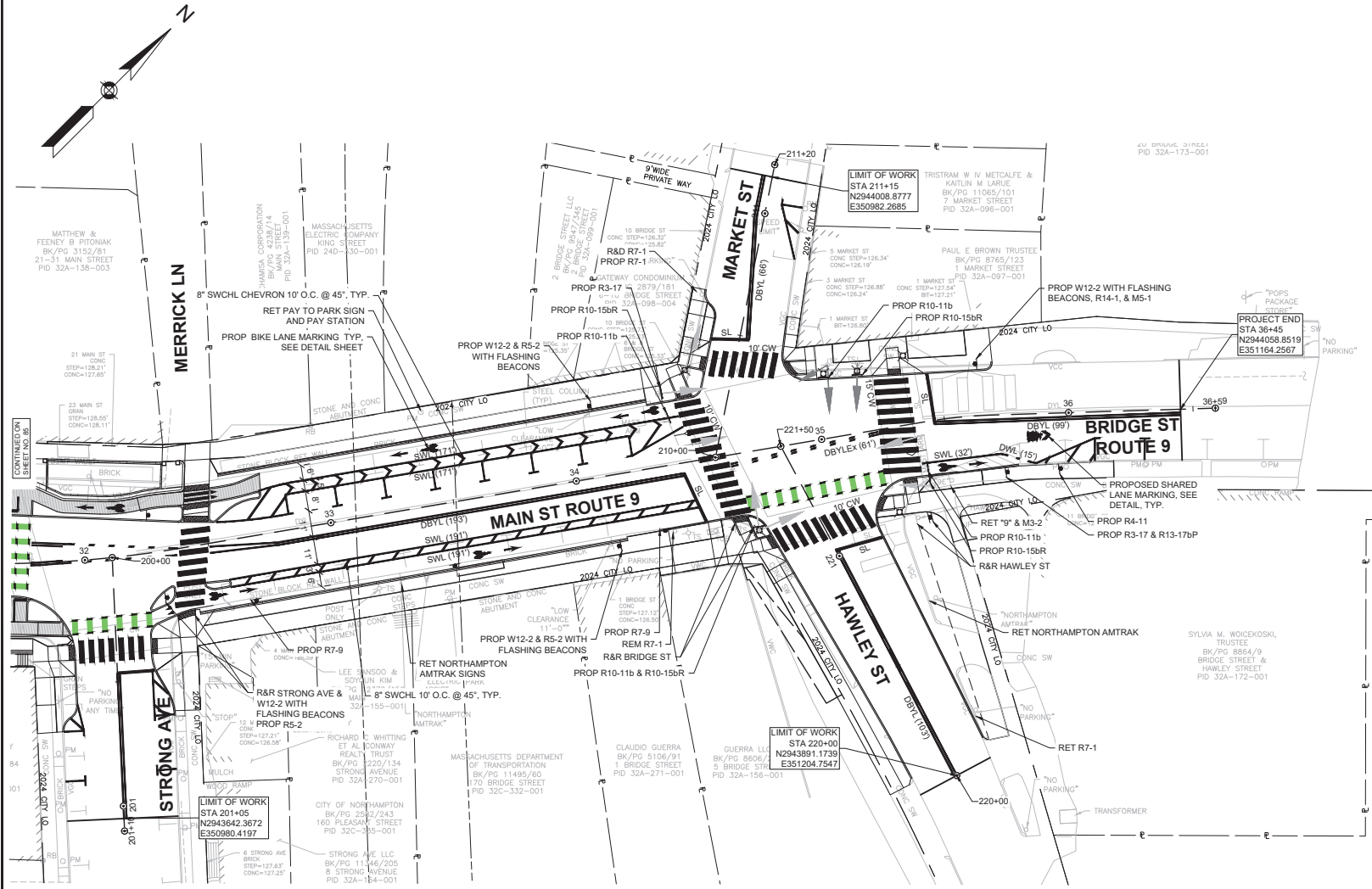

- NOTES:
- ALL EXISTING SIGNAGE TO BE REMOVED UNLESS OTHERWISE NOTED.
 - ALL EXISTING PAVEMENT MARKINGS TO BE REMOVED UNLESS OTHERWISE NOTED.

