

Site Plan for

BOGGY MEADOW ROAD ACCESSIBLE TRAIL

Fitzgerald Lake Conservation Area
197 Cooke Ave, Northampton, Massachusetts

Prepared For:

City of Northampton
Office of Planning & Sustainability
210 Main Street
Northampton, MA 01060

Prepared By:



Landscape Architecture
Civil Engineering
Planning
Land Surveying

4 Allen Place Northampton
Massachusetts 01060
www.berkshiredesign.com

Date:

October 27, 2025 BID SET

Sheet Index

LC-000	COVER
LC-110	SITE PREPARATION PLANS
	LC-111
	LC-112
	LC-113
LC-120	LAYOUT AND GRADING PLANS
	LC-121
	LC-122
	LC-123
LC-501-502	SITE DETAILS

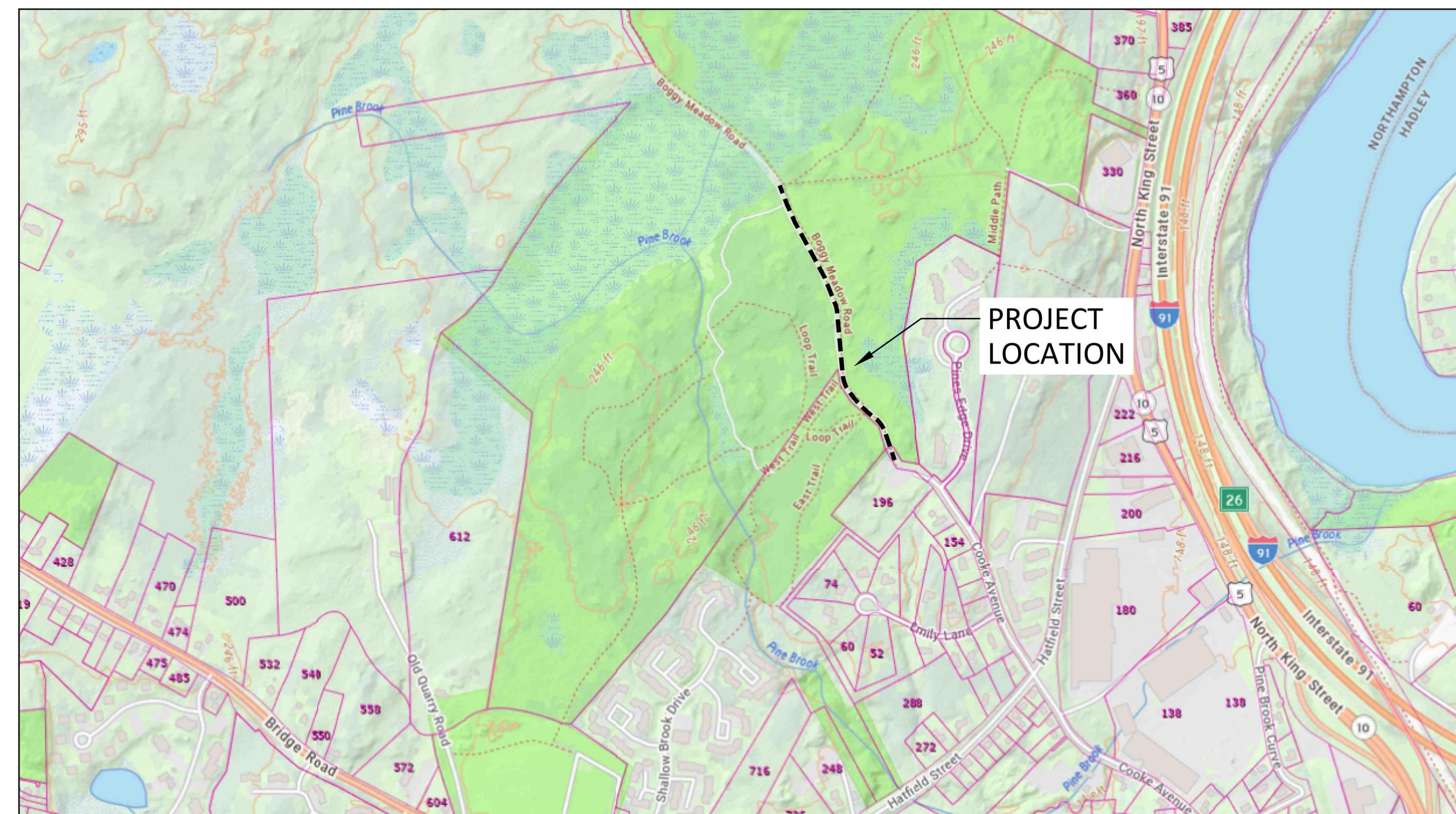

Locus Map

This drawing is not intended nor shall it be used for construction purposes unless the signed professional seal of a registered landscape architect, civil engineer or land surveyor employed by The Berkshire Design Group, Inc. is affixed above.
Do not scale drawing for quantity take-offs or construction. Use written dimensions only. If dimensions are incomplete, contact The Berkshire Design Group, Inc. for clarification.
© Copyright The Berkshire Design Group, Inc.
This drawing and all of its contents are instruments of service of The Berkshire Design Group, Inc. and shall not be copied or used in any way without the written consent of The Berkshire Design Group, Inc.

City of Northampton
Boggy Meadow Road
Accessible Trail
Fitzgerald Lake
Conservation Area

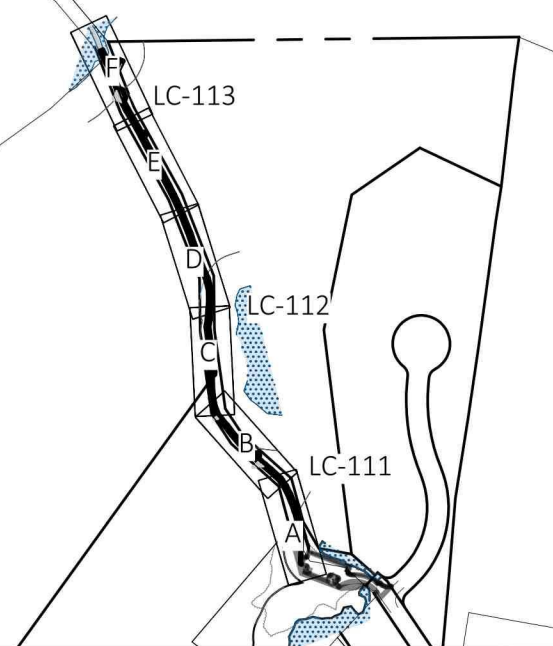

Overall Site Plan

BID SET

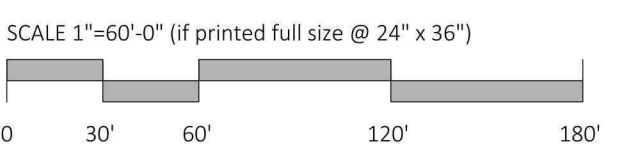

Revisions

NO.	DATE	DESCRIPTION

Date:	October 27, 2025	Sheet Number	LC-110
Scale:	1"=60'		
Drawn By:	MET		
Checked By:	CC		

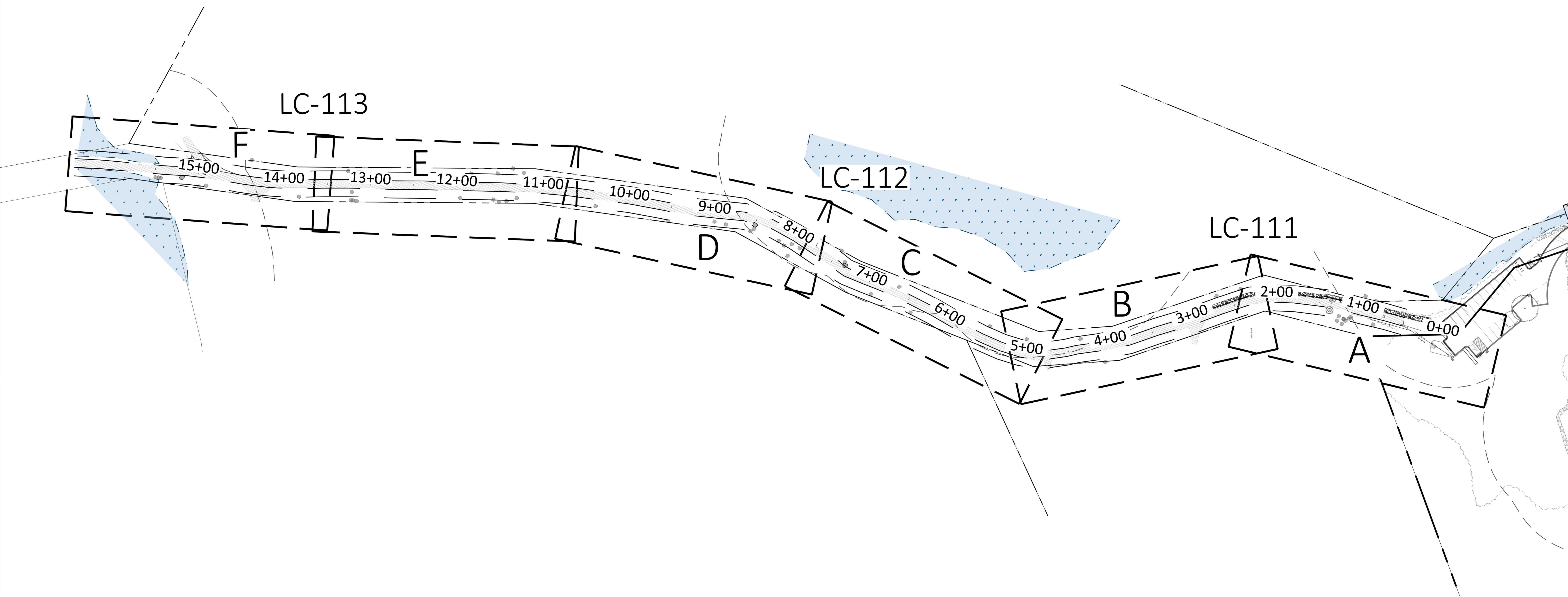

EXISTING CONDITIONS NOTES

- THIS PLAN IS BASED ON PLAN OF LAND IN NORTHAMPTON, MA, PREPARED FOR THE CITY OF NORTHAMPTON, NORTHEAST SURVEY CONSULTANTS, 2015 AND FIELD SURVEY BY BERKSHIRE DESIGN GROUP, 2024.
- BOGGY MEADOW ROAD LAID OUT 40' WIDE AS PER PLAN 166-53; RECORDS OF THE MASSACHUSETTS STATE PLANE COORDINATE SYSTEM (NAD83). THE BASIS OF THE ELEVATIONS DEPICTED HEREON IS A GRID SEPARATION CALCULATION BASED ON GEOID18 RESULTING IN NAVD83. DISTANCES SHOWN ON THIS EXISTING CONDITIONS PLAN ARE GROUND DISTANCES.
- THE BASIS OF BEARINGS, AZIMUTHS, AND THE NORTH ARROW SHOWN HEREON IS THE MASSACHUSETTS STATE PLANE COORDINATE SYSTEM (NAD83). THE BASIS OF THE ELEVATIONS DEPICTED HEREON IS A GRID SEPARATION CALCULATION BASED ON GEOID18 RESULTING IN NAVD83. DISTANCES SHOWN ON THIS EXISTING CONDITIONS PLAN ARE GROUND DISTANCES.
- THIS PLAN IS PREPARED AS A SITE DESIGN AND IS NOT INTENDED TO BE USED FOR DETERMINATION OF PROPERTY LINES. THIS PLAN DOES NOT NECESSARILY SHOW ALL EXISTING EASEMENTS ON THE LOCUS PROPERTY.
- WETLAND AREAS DELINEATED BY WARD SMITH, IN 2024.
- THE CONTRACTOR SHALL FIELD VERIFY ALL EXISTING CONDITIONS. IF A DISCREPANCY IS FOUND BETWEEN THIS PLAN AND THE ACTUAL FIELD CONDITION, THE CONTRACTOR SHALL IMMEDIATELY NOTIFY BERKSHIRE DESIGN GROUP.
- THE LOCATION OF ALL UNDERGROUND UTILITIES SHOWN ARE APPROXIMATE AND ARE BASED UPON A FIELD SURVEY AND COMPILED FROM RECORDS. BERKSHIRE DESIGN GROUP DOES NOT WARRANT THE LOCATION OF ALL UTILITIES DEPICTED. ONLY RECORD INFORMATION PROVIDED BY THE RESPECTIVE UTILITY OWNER AND INDEPENDENTLY VERIFIED BY BERKSHIRE DESIGN GROUP IS SHOWN HEREON. PRIOR TO THE START OF WORK, THE CONTRACTOR SHALL VERIFY THE LOCATION OF ALL UTILITIES AND CONTACT DIG SAFE AT 811.
- BERKSHIRE DESIGN GROUP'S EXISTING SURVEY CONTROL DATA WILL NOT BE PROVIDED TO THE CONTRACTOR. IF REQUESTED, BERKSHIRE DESIGN GROUP WILL PROVIDE SURVEY LAYOUT SERVICES AND/OR SET NEW SURVEY CONTROL POINTS FOR CONSTRUCTION AT THE CONTRACTOR'S EXPENSE.

SITE PREPARATION/DEMOLITION NOTES

- A TRENCH PERMIT MAY BE REQUIRED FROM THE CITY OF NORTHAMPTON DPW.
- FORMER LODGE LOCATION ADJACENT TO THE SITE ENTRANCE MAY BE USED FOR STAGING AREA IF CONTRACTOR NEGOTIATES PERMISSION FROM OWNER. STAGING AREAS SHALL BE SURROUNDED WITH EROSION CONTROL AND RESTORED TO EXISTING CONDITIONS.
- EXISTING BASE MATERIAL MAY BE REUSED ONSITE FOR THE PROPOSED TRAIL BASE MATERIAL IF CONTRACTOR DEMONSTRATES THAT THE ON-SITE MATERIAL MEETS THE MATERIAL SPECIFICATIONS.
- THE CONTRACTOR SHALL BE RESPONSIBLE FOR A THOROUGH SITE EXAMINATION TO DETERMINE THE EXTENT OF DEMOLITION NECESSARY TO PREPARE THE SITE FOR CONSTRUCTION AND SHALL VERIFY ALL ITEMS TO BE DEMOLISHED OR SALVAGED WITH BERKSHIRE DESIGN GROUP PRIOR TO BEGINNING WORK.
- CARE SHALL BE TAKEN NOT TO DAMAGE ANY ITEMS DESIGNATED TO REMAIN, REPAIR OR REPLACEMENT OF DAMAGED ITEMS DESIGNATED TO REMAIN SHALL BE AT THE CONTRACTOR'S EXPENSE.
- AREAS OUTSIDE THE LIMITS OF PROPOSED WORK DISTURBED BY THE CONTRACTOR'S OPERATIONS SHALL BE RESTORED BY THE CONTRACTOR TO THEIR ORIGINAL CONDITION AT THE CONTRACTOR'S EXPENSE.
- DISPOSAL OF PROPERTY DESIGNATED TO BE REMOVED SHALL BE AT THE DIRECTION OF BERKSHIRE DESIGN GROUP OR OWNER, AND SHALL CONFORM TO ALL APPLICABLE LAWS AND REGULATIONS. ALL SALVAGEABLE MATERIAL SHALL BE DELIVERED BY THE CONTRACTOR TO STORAGE AREAS DESIGNATED BY BERKSHIRE DESIGN GROUP OR THE OWNER. CONTRACTOR SHALL REMOVE ALL EXISTING UNSUITABLE MATERIALS FROM THE SITE.
- THE CONTRACTOR SHALL CLEAR AND GRUB ALL AREAS WITHIN THE LIMIT OF GRADING.

- THE CONTRACTOR SHALL PROTECT EXISTING TREES TO REMAIN AS SHOWN ON THE PLANS AND DETAILS.
- THE CONTRACTOR SHALL PERFORM THE WORK SUCH THAT ALL TREES TO REMAIN ARE PROTECTED FROM DAMAGE. THIS INCLUDES PROTECTION FROM:
 - COMPACTION BY TRACKED MACHINERY
 - ROOT DAMAGE FROM MECHANIZED EXCAVATION.
 - DEHYDRATION FROM ROOT EXPOSURE.
 - TRUNK AND CANOPY DAMAGE.
- ALL STRIPPED TOPSOIL TO BE RE-USED SHALL BE SCREENED AND STOCKPILED IN AN AREA DESIGNATED BY BERKSHIRE DESIGN GROUP OR THE OWNER. ANY EXCESS TOPSOIL THAT WILL NOT BE INCORPORATED INTO THE WORK SHALL BE REMOVED FROM THE SITE. THE CONTRACTOR IS RESPONSIBLE FOR ALL TOPSOIL AS NEEDED TO MEET THE SPECIFICATIONS.
- THE CONTRACTOR MAY PROPOSE ALTERNATIVE STAGING/STORAGE AREAS TO BE APPROVED BY THE OWNER AND ENGINEER PRIOR TO THE START OF WORK. ALL STAGING AREAS SHALL BE SURROUNDED BY SILT FENCE TRENCHED INTO THE GROUND TO PREVENT SEDIMENT LEAVING SITE.
- THE CONTRACTOR SHALL BE RESPONSIBLE FOR ANY AND ALL EROSION CONTROLS NECESSARY TO PREVENT SEDIMENT FROM LEAVING THE SITE. AT A MINIMUM, PROVIDE A VEHICLE TRACKING PAD AT THE SITE ENTRANCE, AND INSTALL SILT FENCE AT THE LOCATIONS SHOWN ON THIS SHEET.
- ALL AREAS DISTURBED FROM CONSTRUCTION ACTIVITY TO BE RAKED, SMOOTHED, AND SEEDED UNLESS OTHERWISE NOTED. REFER TO SEEDING NOTES FOR ADDITIONAL DETAILS.

- THE CONTRACTOR MAY USE TEMPORARY FENCING TO CONTROL THE SITE DURING CONSTRUCTION. PRIOR TO THE FINAL COMPLETION OF THE PROJECT, THE CONTRACTOR SHALL REMOVE ALL TEMPORARY FENCING AND BARRICADES.
- PRIOR TO CONSTRUCTION, THE CONTRACTOR SHALL VERIFY THE LOCATION OF UNDERGROUND UTILITIES. UNDERGROUND UTILITIES TO REMAIN SHALL BE PROTECTED DURING THE COURSE OF THE WORK. THE CONTRACTOR SHALL BE RESPONSIBLE FOR REPAIR OF UTILITIES DAMAGED BY CONSTRUCTION ACTIVITIES, REGARDLESS OF WHETHER THE UTILITY THAT WAS DAMAGED WAS SHOWN ON THE PLANS.
- ALL PROPERTY BOUNDARY MONUMENTS SHALL BE PROTECTED DURING CONSTRUCTION. THE CONTRACTOR SHALL BE RESPONSIBLE FOR OBTAINING THE SERVICES OF A PROFESSIONAL LAND SURVEYOR TO RE-SET OR REPLACE ANY MONUMENT DAMAGED OR ALTERED BY CONSTRUCTION ACTIVITIES.

EROSION CONTROL NOTES

- THE CONTRACTOR SHALL INSTALL EROSION CONTROL DEVICES AS NECESSARY TO PREVENT EROSION WITHIN THE SITE AND MIGRATION OF SEDIMENT OFF OF THE SITE, OR AS DIRECTED BY BERKSHIRE DESIGN GROUP. ALL DEVICES SHALL COMPLY WITH THE MASSACHUSETTS EROSION AND SEDIMENT CONTROL GUIDELINES FOR URBAN AND SUBURBAN AREAS, CURRENT VERSION, PUBLISHED BY MASSDEP.
- THE CONTRACTOR SHALL INSPECT ALL INSTALLED EROSION CONTROL DEVICES AT LEAST WEEKLY AND AFTER EACH STORM. IF ANY DEVICE IS FOUND TO BE DAMAGED, THE CONTRACTOR SHALL REPAIR IT IMMEDIATELY. IF SEDIMENT IS FOUND TO FILL MORE THAN HALF THE HEIGHT OF THE DEVICE, THE SEDIMENT SHALL BE REMOVED OR THE DEVICE REPLACED.
- NATURAL VEGETATION SHALL BE RETAINED WHEREVER FEASIBLE UP TO THE SCHEDULED START OF CONSTRUCTION ACTIVITY IN THE AREA. WHERE POSSIBLE, CLEARING SHALL IMMEDIATELY PRECEDE CONSTRUCTION ACTIVITY.
- ALL VEHICLES ENTERING AND EXITING THE SITE SHALL BE REQUIRED TO CROSS A TRACKING PAD TO PREVENT TRACKING OF SEDIMENT ONTO PUBLIC ROADWAYS. IF SEDIMENT IS FOUND ON ROADWAYS, THE SEDIMENT SHALL BE REMOVED IMMEDIATELY.
- THE CONTRACTOR SHALL INSTALL EROSION CONTROL BARRIER ALONG ALL DOWN-SLOPE SITE LIMITS WITHIN/ ADJACENT TO WETLAND RESOURCE AREAS AND BUFFER ZONE.
- THE CONTRACTOR SHALL UTILIZE EROSION CONTROL BLANKET TO PROTECT ALL SLOPES STEEPER THAN 3H:1V UNTIL PERMANENTLY STABILIZED. BIODEGRADABLE NETTING SHALL BE USED. PHOTODEGRADABLE PLASTIC NETTING WILL NOT BE ACCEPTED.
- ALL SOIL STOCKPILES SHALL BE SURROUNDED BY A CONTINUOUS SILT FENCE. IF THE STOCKPILE WILL REMAIN UNUSED FOR MORE THAN 30

- THE STOCKPILE SHALL BE STABILIZED BY TEMPORARY SEEDING OR OTHER APPROVED METHOD.
- ALL DEWATERING DISCHARGES SHALL BE DIRECTED TO A DEWATERING SEDIMENT TRAP.
- THE CONTRACTOR SHALL MAINTAIN A STOCKPILE OF EXTRA EROSION CONTROL MATERIALS THAT MEET THE REQUIREMENTS OF THE CONTRACT DOCUMENTS ON SITE AT ALL TIMES.
- THE CONTRACTOR SHALL MONITOR WEATHER THROUGHOUT THE PROJECT AND PREPARE THE SITE IN ADVANCE OF SEVERE WEATHER IN ORDER TO PREVENT DAMAGE TO WORK IN PLACE AND SEDIMENT MIGRATION OFF OF THE SITE.
- THE CONTRACTOR SHALL IMPLEMENT SPILL-PREVENTION PROCEDURES AND MAINTAIN A SPILL PREVENTION AND CLEANUP PLAN FOR THE SITE. ALL MATERIALS THAT ARE CAPABLE OF SPILLING, LEAKING, DISSOLVING OR OTHERWISE POLLUTING STORMWATER RUNOFF SHALL BE COVERED WHILE STORED AT THE SITE.
- ALL SEDIMENT REMOVED FROM THE SITE SHALL BE HANDLED IN ACCORDANCE WITH STATE AND LOCAL REGULATIONS.
- ALL TEMPORARY EROSION CONTROLS SHALL REMAIN IN PLACE UNTIL THE SITE IS FULLY STABILIZED. AFTER STABILIZATION, TEMPORARY EROSION CONTROLS SHALL BE REMOVED FROM THE SITE PRIOR TO THE COMPLETION OF THE WORK.

E:\NORTHAMPTON - BOGGY MEADOW RD ADA TRAIL\UD-DESIGN PROCESS\DRAWINGS\CL-110 - SITE PREP PLANS - BOGGY MEADOWS RD.DWG - PLOT DATE: 10/27/2025

MATCHLINE SEE SHEET LC-102

LC-111 A

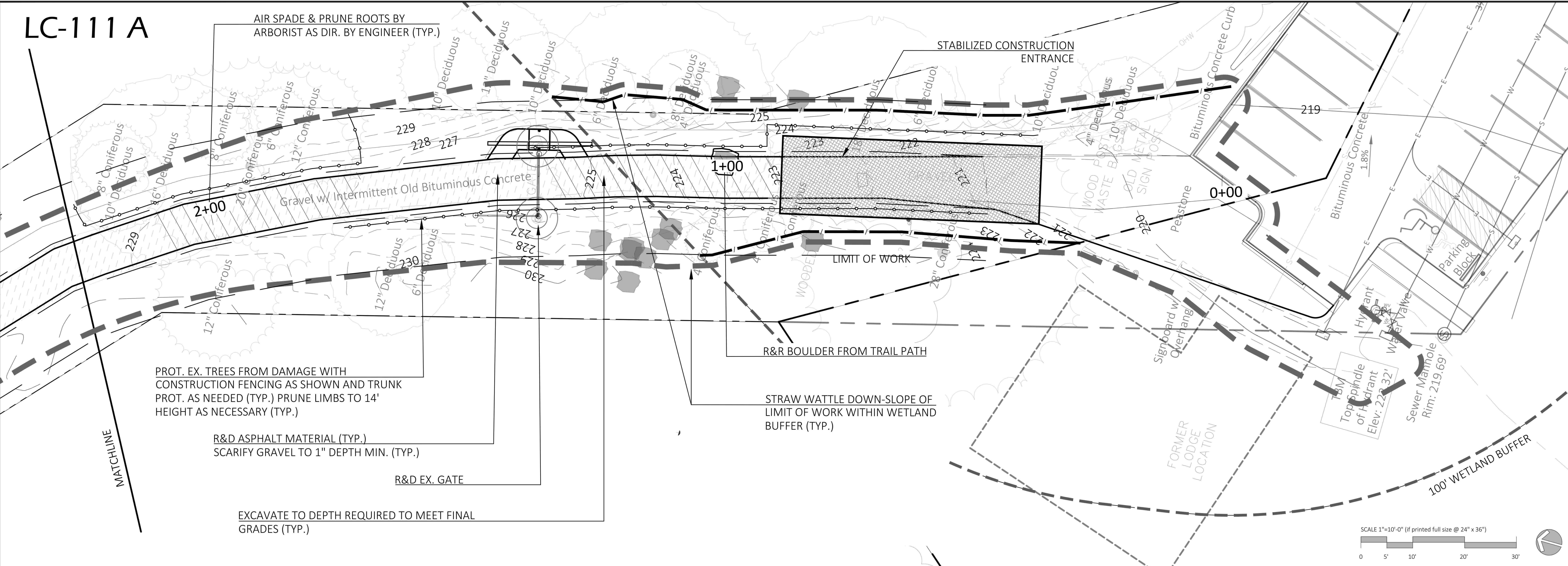

PROT. EX. TREES FROM DAMAGE WITH CONSTRUCTION FENCING AS SHOWN AND TRUNK PROT. AS NEEDED (TYP.) PRUNE LIMBS TO 14' HEIGHT AS NECESSARY (TYP.)

R&D ASPHALT MATERIAL (TYP.) SCARIFY GRAVEL TO 1" DEPTH MIN. (TYP.)

R&D EX. GATE

EXCAVATE TO DEPTH REQUIRED TO MEET FINAL GRADES (TYP.)

AIR SPADE & PRUNE ROOTS BY ARBORIST AS DIR. BY ENGINEER (TYP.)

STABILIZED CONSTRUCTION ENTRANCE

LIMIT OF WORK

STRAW WATTLE DOWN-SLOPE OF LIMIT OF WORK WITHIN WETLAND BUFFER (TYP.)

R&R BOULDER FROM TRAIL PATH

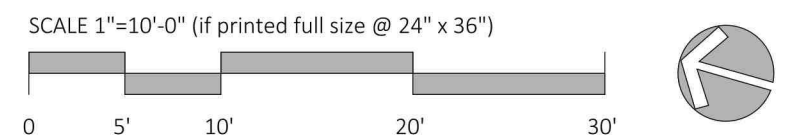

Berkshire Design Group
 Landscape Architecture
 Civil Engineering
 Planning
 Land Surveying

4 Allen Place, Northampton, Massachusetts 01060
 Email: bdg@berkshiredesign.com
 Web: http://www.berkshiredesign.com
 Phone: (413) 582-7000

This drawing is not intended nor shall it be used for construction purposes unless the signed professional seal of a registered landscape architect, civil engineer or land surveyor employed by The Berkshire Design Group, Inc. is affixed above.

Do not scale drawing for quantity take-offs or construction. Use written dimensions only. If dimensions are incomplete, contact The Berkshire Design Group, Inc. for clarification.

© Copyright The Berkshire Design Group, Inc.
 This drawing and all of its contents are instruments of service of The Berkshire Design Group, Inc. and shall not be copied or used in any way without the written consent of The Berkshire Design Group, Inc.

City of Northampton
 Bogy Meadow Road
 Accessible Trail
 Fitzgerald Lake
 Conservation Area

LC-111 B

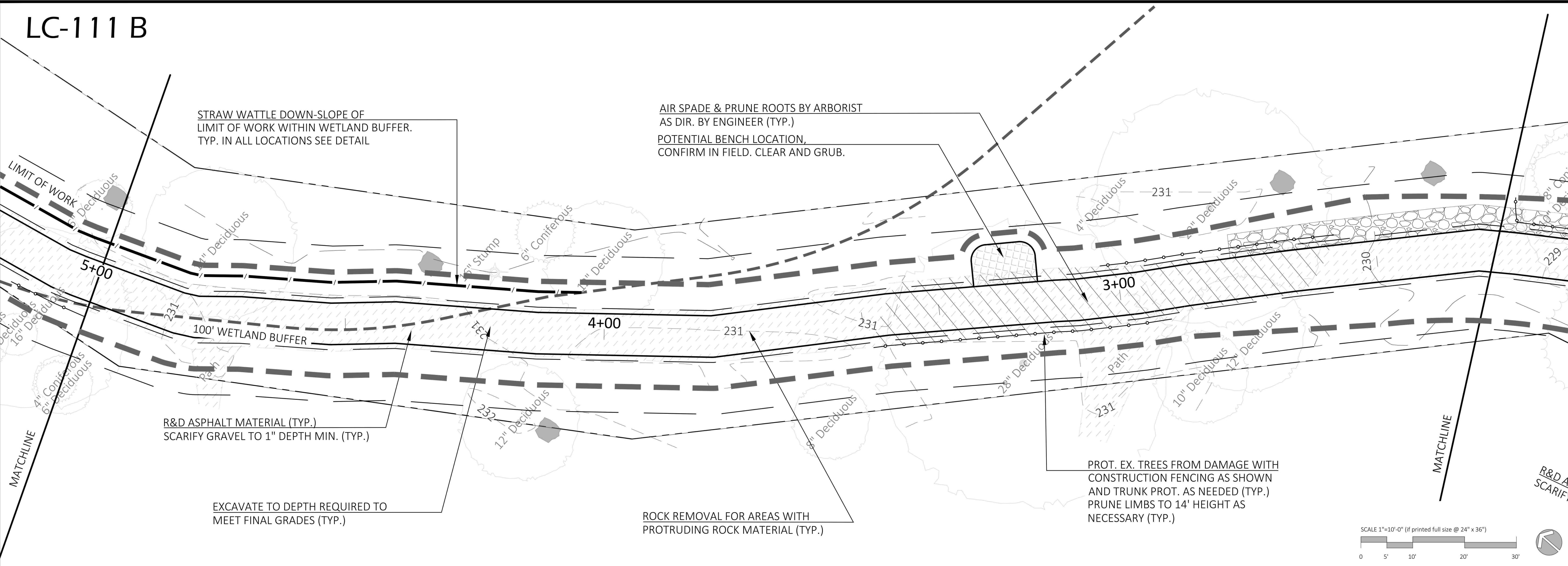

STRAW WATTLE DOWN-SLOPE OF LIMIT OF WORK WITHIN WETLAND BUFFER. TYP. IN ALL LOCATIONS SEE DETAIL

AIR SPADE & PRUNE ROOTS BY ARBORIST AS DIR. BY ENGINEER (TYP.)
 POTENTIAL BENCH LOCATION. CONFIRM IN FIELD. CLEAR AND GRUB.

R&D ASPHALT MATERIAL (TYP.) SCARIFY GRAVEL TO 1" DEPTH MIN. (TYP.)

EXCAVATE TO DEPTH REQUIRED TO MEET FINAL GRADES (TYP.)

ROCK REMOVAL FOR AREAS WITH PROTRUDING ROCK MATERIAL (TYP.)

PROT. EX. TREES FROM DAMAGE WITH CONSTRUCTION FENCING AS SHOWN AND TRUNK PROT. AS NEEDED (TYP.) PRUNE LIMBS TO 14' HEIGHT AS NECESSARY (TYP.)

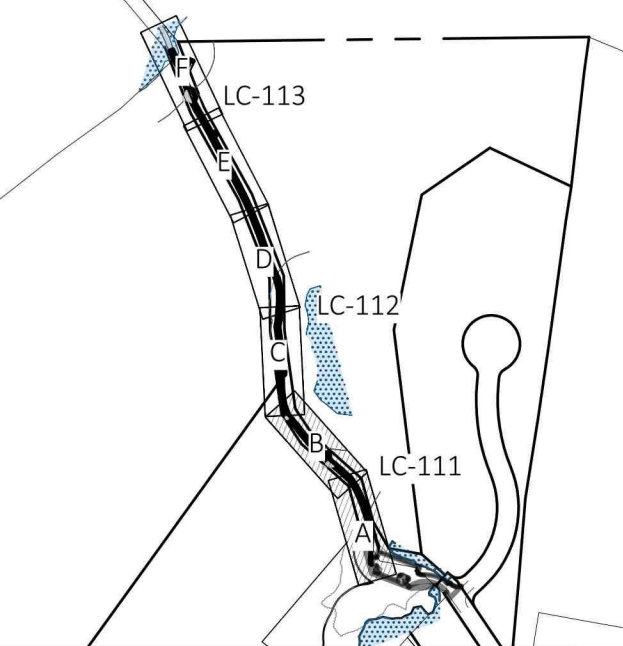
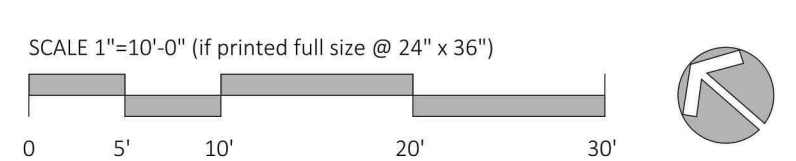

Site Demolition & Erosion Control Plan

BID SET

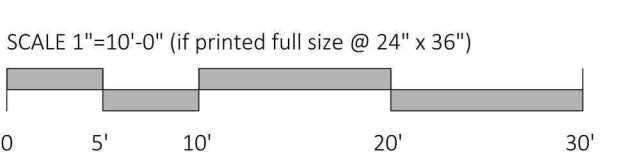

Revisions	

Date: October 27, 2025
 Scale: 1"=20'
 Drawn By: MET
 Checked By: CC

Sheet Number
LC-111

E:\NORTHAMPTON - BOGGEY MEADOW RD ADA TRAIL\LD DESIGN\PROCESSING\DRAWINGS\110 - SITE PREP PLANS - BOGGEY MEADOW RD.DWG - PLOT DATE: 10/27/2025

LC-112 C

PROT. EX. TREES FROM DAMAGE WITH CONSTRUCTION FENCING AS SHOWN AND TRUNK PROT. AS NEEDED (TYP.) PRUNE LIMBS TO 14' HEIGHT AS NECESSARY (TYP.)

STRAW WATTLE DOWN-SLOPE OF LIMIT OF WORK WITHIN WETLAND BUFFER. TYP. IN ALL LOCATIONS SEE DETAIL

R&D ASPHALT MATERIAL (TYP.) SCARIFY GRAVEL TO 1" DEPTH MIN. (TYP.)

R&R BOULDER FROM TRAIL PATH

LIMIT OF WORK

EXCAVATE TO DEPTH REQUIRED TO MEET FINAL GRADES (TYP.)

ROCK REMOVAL FOR AREAS WITH PROTRUDING ROCK MATERIAL (TYP.)

POTENTIAL BENCH LOCATION, CONFIRM IN FIELD. CLEAR AND GRUB, TYP.

AIR SPADE & PRUNE ROOTS BY ARBORIST AS DIR. BY ENGINEER (TYP.)

SCALE 1"=10'-0" (if printed full size @ 24" x 36")



This drawing is not intended nor shall it be used for construction purposes unless the signed professional seal of a registered landscape architect, civil engineer or land surveyor employed by The Berkshire Design Group, Inc. is affixed above.
Do not scale drawings for quantity take-offs or construction. Use written dimensions only. If dimensions are incomplete, contact The Berkshire Design Group, Inc. for clarification.
© Copyright The Berkshire Design Group, Inc.
This drawing and all of its contents are instruments of service of The Berkshire Design Group, Inc. and shall not be copied or used in any way without the written consent of The Berkshire Design Group, Inc.

City of Northampton
Boggy Meadow Road
Accessible Trail
Fitzgerald Lake
Conservation Area

LC-112 D

R&R BOULDER FROM TRAIL PATH

ROCK REMOVAL FOR AREAS WITH PROTRUDING ROCK MATERIAL (TYP.)

POTENTIAL BENCH LOCATION, CONFIRM IN FIELD. CLEAR AND GRUB, TYP.

10+00

LIMIT OF WORK

AIR SPADE & PRUNE ROOTS BY ARBORIST AS DIR. BY ENGINEER (TYP.)

R&D ASPHALT MATERIAL (TYP.) SCARIFY GRAVEL TO 1" DEPTH MIN. (TYP.)

EXCAVATE TO DEPTH REQUIRED TO MEET FINAL GRADES (TYP.)

PROT. EX. TREES FROM DAMAGE WITH CONSTRUCTION FENCING AS SHOWN AND TRUNK PROT. AS NEEDED (TYP.) PRUNE LIMBS TO 14' HEIGHT AS NECESSARY (TYP.)

STRAW WATTLE DOWN-SLOPE OF LIMIT OF WORK WITHIN WETLAND BUFFER (TYP.)

SCALE 1"=10'-0" (if printed full size @ 24" x 36")

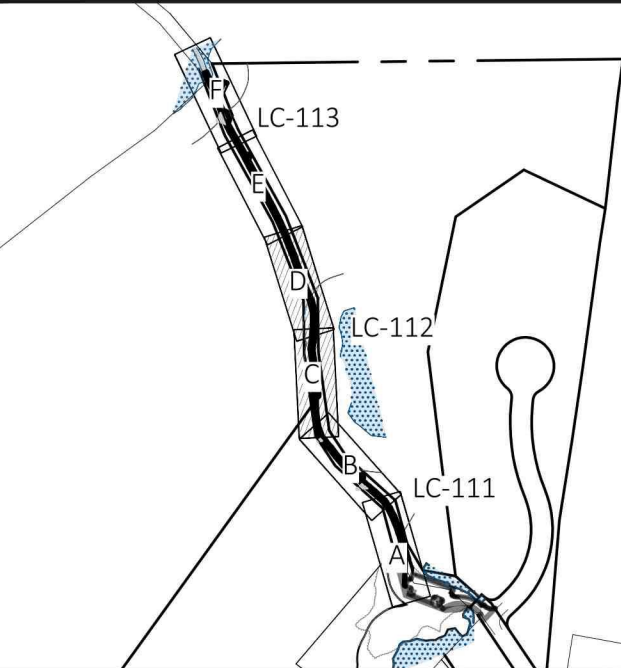

Site Demolition & Erosion Control Plan

BID SET

SCALE 1"=10'-0" (if printed full size @ 24" x 36")

Revisions	

Date:	October 27, 2025	Sheet Number	
Scale:	1"=20'	LC-112	
Drawn By:	MET		
Checked By:	CC		

LC-113 E

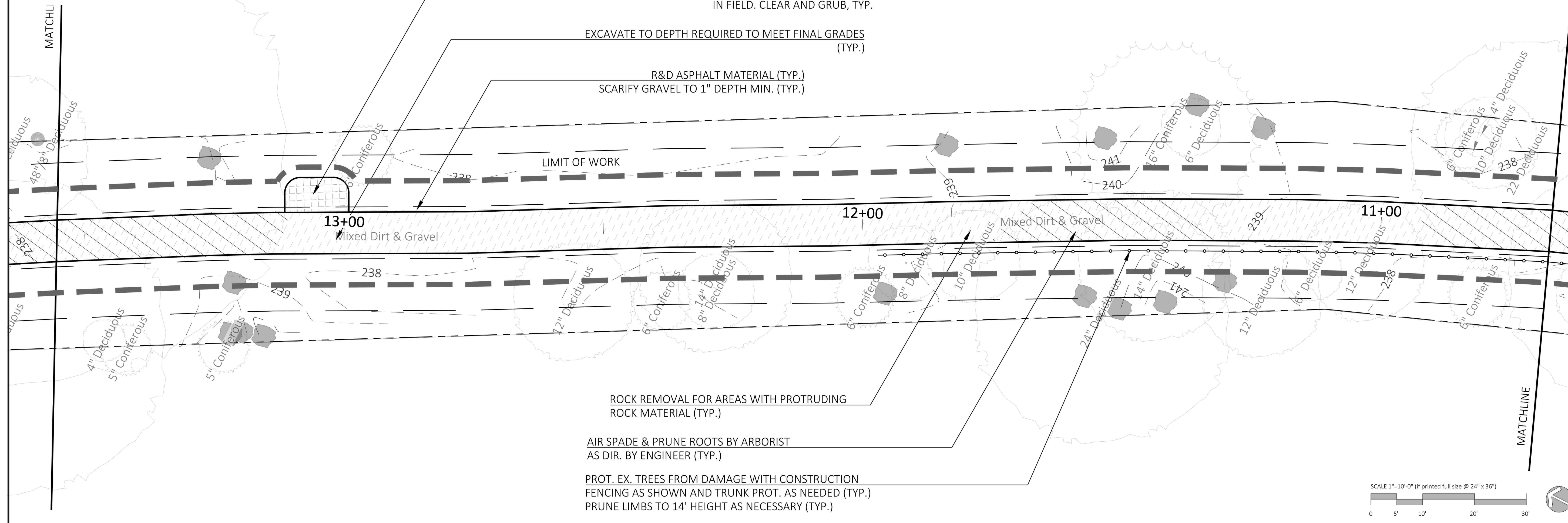

Berkshire Design Group
 Landscape Architecture
 Civil Engineering
 Planning
 Land Surveying

4 Allen Place, Northampton, Massachusetts 01060
 Email: bdg@berkshiredesign.com
 Web: http://www.berkshiredesign.com
 Phone: (413) 582-7000

This drawing is not intended nor shall it be used for construction purposes unless the signed professional seal of a registered landscape architect, civil engineer or land surveyor employed by The Berkshire Design Group, Inc. is affixed above.
 Do not scale drawings for quantity take-offs or construction. Use written dimensions only. If dimensions are incomplete, contact The Berkshire Design Group Inc. for clarification.
 © Copyright The Berkshire Design Group, Inc.
 This drawing and all of its contents are instruments of service of The Berkshire Design Group, Inc. and shall not be copied or used in any way without the written consent of The Berkshire Design Group, Inc.

City of Northampton
 Boggy Meadow Road
 Accessible Trail
 Fitzgerald Lake
 Conservation Area

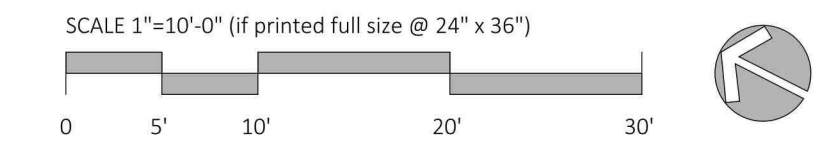

LC-113 F

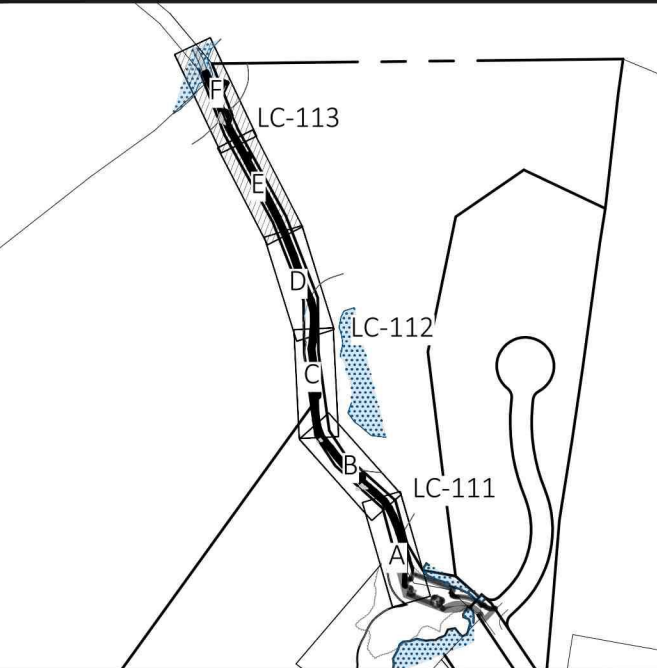
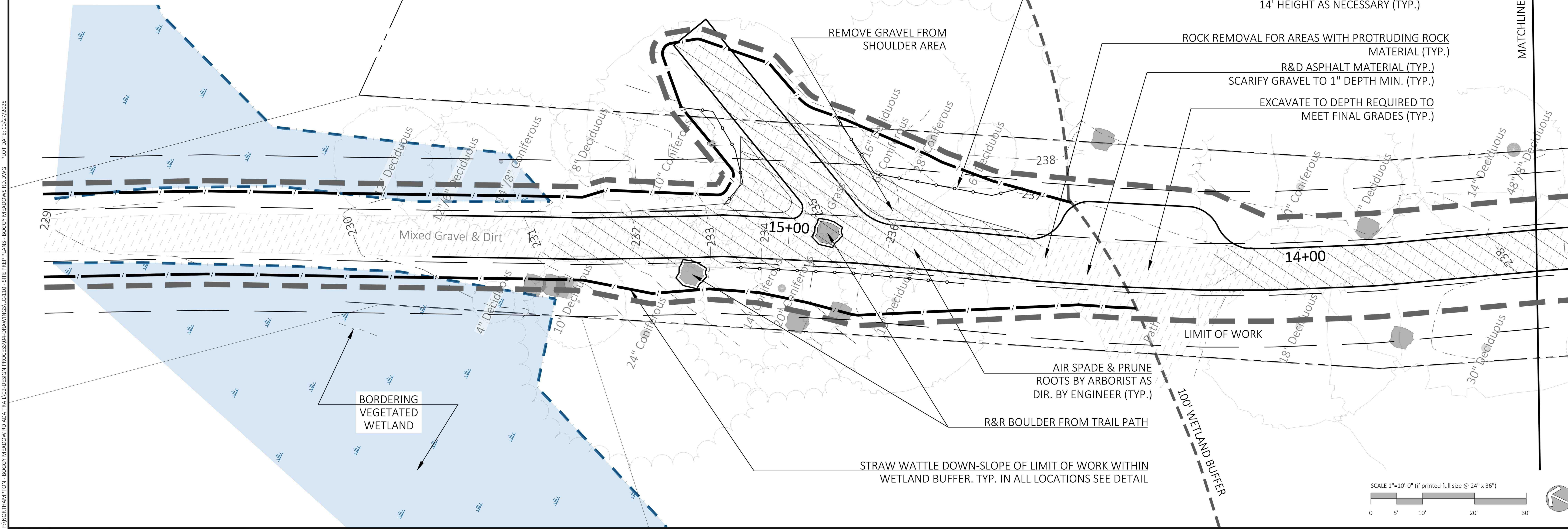

Site Demolition &
 Erosion Control Plan

BID SET

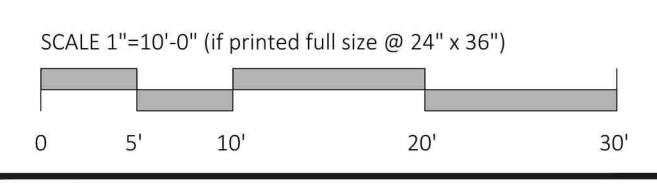

Revisions

NO.	DATE	DESCRIPTION

Date: October 27, 2025
 Scale: 1"=20'
 Drawn By: MET
 Checked By: CC

Sheet Number
LC-113

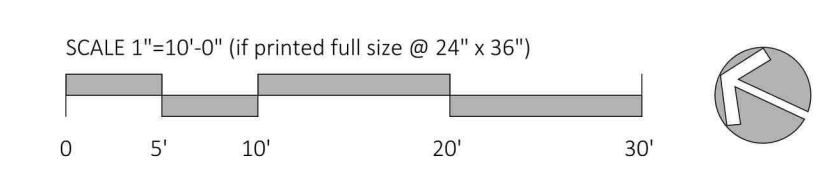

E:\NORTHAMPTON - BOGGY MEADOW RD ADA TRAIL\LD-DESIGN\PROCESSING\DRAWINGS\LC-113 - SITE PREP PLANS - BOGGY MEADOW RD.DWG - PLOT DATE: 10/27/2025

This drawing is not intended nor shall it be used for construction purposes unless the signed professional seal of a registered landscape architect, civil engineer or land surveyor employed by The Berkshire Design Group, Inc. is affixed above.

Do not scale drawing for quantity take-offs or construction. Use written dimensions only. If dimensions are incomplete, contact The Berkshire Design Group, Inc. for clarification.

© Copyright The Berkshire Design Group, Inc.
This drawing and all of its contents are instruments of service of The Berkshire Design Group, Inc. and shall not be copied or used in any way without the written consent of The Berkshire Design Group, Inc.

City of Northampton
Boggy Meadow Road
Accessible Trail
Fitzgerald Lake
Conservation Area

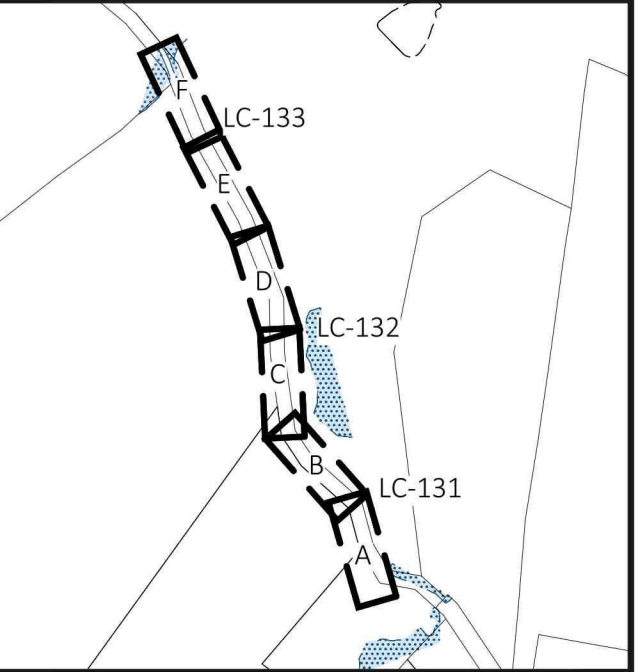

Overall Site Plan

BID SET

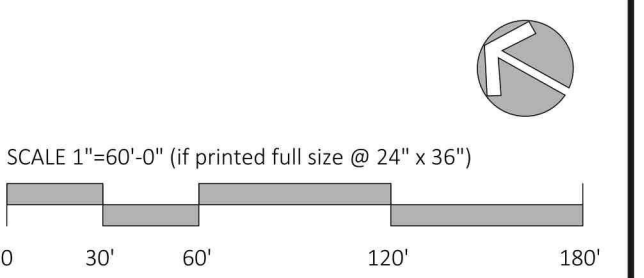

Revisions	

Date:	October 27, 2025	Sheet Number	LC-120
Scale:	1"=60'		
Drawn By:	MET		
Checked By:	CC		

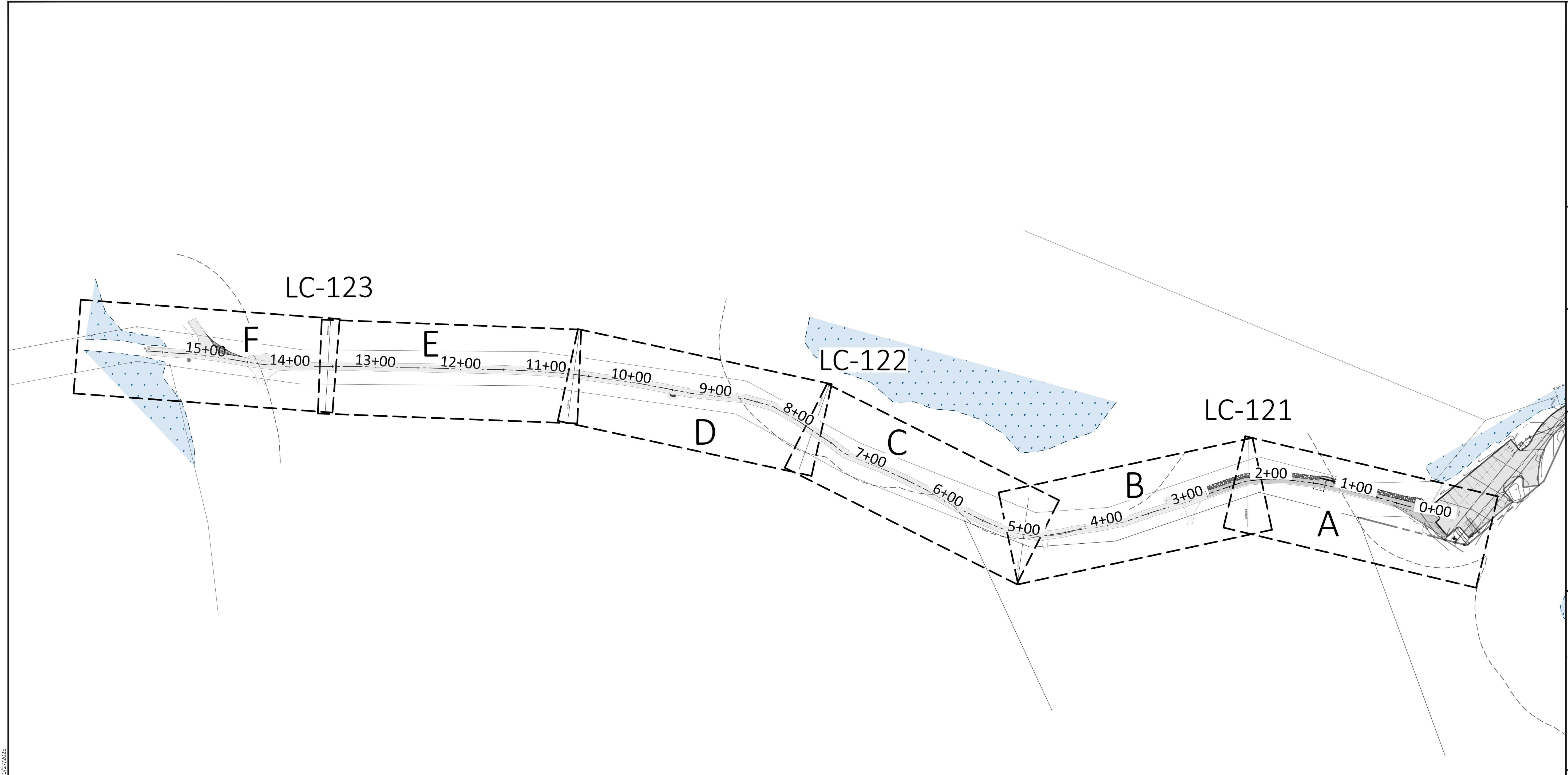

- LAYOUT NOTES**
- ALL LINES OR POINTS ARE PERPENDICULAR OR PARALLEL TO LINES FROM WHICH THEY ARE MEASURED UNLESS OTHERWISE NOTED; WRITTEN DIMENSIONS SHALL PREVAIL.
 - THE CONTRACTOR SHALL VERIFY ALL LAYOUT, DIMENSIONS, GRADES, AND INVERTS PRIOR TO CONSTRUCTION; REPORT ANY DISCREPANCIES TO BERKSHIRE DESIGN GROUP. ALL DISCREPANCIES SHALL BE RESOLVED IN WRITING PRIOR TO BEGINNING WORK.
 - ALL MATERIALS AND CONSTRUCTION METHODS SHALL CONFORM TO THE CONSTRUCTION STANDARDS AND SPECIFICATIONS OF THE CITY OF NORTHAMPTON AND THE MASSACHUSETTS DEPARTMENT OF TRANSPORTATION.
 - EXISTING BASE MATERIAL MAY BE REUSED ONSITE FOR THE PROPOSED TRAIL BASE MATERIAL IF CONTRACTOR DEMONSTRATES THAT THE ON-SITE MATERIAL MEETS THE MATERIAL SPECIFICATIONS.
 - PRIOR TO ANY EXCAVATION WORK, THE CONTRACTOR SHALL OBTAIN A TRENCH PERMIT FROM THE NORTHAMPTON DPW. THIS PROJECT IS FOR THE CITY OF NORTHAMPTON; THEREFORE, THE TRENCH PERMIT FEE WILL BE WAIVED.
 - ALL AREAS DISTURBED FROM CONSTRUCTION ACTIVITY TO BE RAKED, SMOOTHED, FERTILIZED AND SEEDED UNLESS OTHERWISE NOTED. SEE SEEDING NOTES.
 - ALL NEW WALKS AND SURFACES TO MEET EXISTING WALKS AND SURFACES WITH SMOOTH, CONTINUOUS LINE AND GRADE.
 - THE CONTRACTOR SHALL NOT INSTALL CONCRETE, ASPHALT, RUBBER, AND OTHER HARDSCAPE SURFACING DURING ADVERSE WEATHER CONDITIONS (RAIN, SLEET, ETC.).
 - THE CONTRACTOR SHALL REMOVE AND DISPOSE OF ALL EXCESS OR SPILLED CONCRETE, ASPHALT, AGGREGATE AND OTHER MATERIALS FROM THE SITE.
 - DEVIATIONS FROM THE PROPOSED PLAN SHALL BE APPROVED IN WRITING BY THE ENGINEER PRIOR TO PERFORMANCE OF THE WORK. SUCH CHANGES SHALL BE RECORDED BY THE CONTRACTOR ON A "RED LINE" AS-BUILT DRAWING. IF THE CONTRACTOR PROPOSES, AND THE ENGINEER APPROVES, AN ALTERATION TO THE HORIZONTAL ALIGNMENT THE AS-BUILT OF THE ALIGNMENT SHALL BE CERTIFIED BY A MASSACHUSETTS PROFESSIONAL LAND SURVEYOR.
 - CAD FILES FOR THE PROJECT WILL BE MADE AVAILABLE BY BERKSHIRE DESIGN GROUP FOR THE CONVENIENCE OF THE CONTRACTOR UPON REQUEST. THE CONTRACTOR SHALL BE BOUND BY BERKSHIRE DESIGN GROUP'S TERMS AND CONDITIONS FOR USE OF ELECTRONIC FILES. EXISTING SURVEY CONTROL DATA WILL NOT BE PROVIDED.

- GENERAL SEEDING NOTES**
- ALL AREAS DISTURBED FROM CONSTRUCTION ACTIVITY TO BE RAKED, SMOOTHED, FERTILIZED AND SEEDED UNLESS OTHERWISE NOTED.
 - SEED MIX SHALL BE "NEW ENGLAND SEMI-SHADE GRASS AND FORBS MIX" FROM NEW ENGLAND WETLAND PLANTS, OR APPROVED EQUAL TURF GRASS WILL NOT BE ACCEPTED.
 - ALL SEEDED AREAS SHALL RECEIVE A MINIMUM SCREENED LOAM DEPTH OF 4".
 - THE CONTRACTOR SHALL SUPPLY LOAM WHICH SHALL BE PREPARED BY THE CONTRACTOR SO AS TO BE FREE FROM SUBSOIL, STUMPS, ROOTS, STONES OVER ONE (1) INCH DIAMETER AND OTHER EXTRANEEOUS MATERIALS.
 - ON-SITE SOILS PROPOSED TO BE RE-USED SHALL BE SIFTED TO REMOVE ALL TWIGS, STICKS, AND STONES, AND STOCKPILED ON-SITE. THE CONTRACTOR SHALL REMOVE AND DISPOSE OF ALL EXCESS SOILS THAT WILL NOT BE INCORPORATED INTO THE PROJECT.
 - THE CONTRACTOR SHALL BE RESPONSIBLE FOR TESTING OF IMPORTED TOPSOIL BY A LOCAL TESTING AGENCY FOR SOIL STRUCTURE (SOIL PARTICLE SIZE ANALYSIS), ROUTINE SOIL ANALYSIS, FERTILITY, ORGANIC CONTENT, AND SOLUBLE SALTS. TOPSOIL SHALL BE AMENDED AS PER RECOMMENDATIONS OF THE TESTING AGENCY.
 - FOR SEEDING OF RAIN GARDENS AND VEGETATED SWALES, SEE DETAILS FOR THOSE FEATURES.
 - ALL NEW WALKS AND SURFACES TO MEET EXISTING WALKS AND SURFACES WITH SMOOTH, CONTINUOUS LINE AND GRADE.

- GRADING NOTES**
- ALL SIDEWALKS/WALKWAYS SHALL CONFORM TO THE MASSACHUSETTS ARCHITECTURAL ACCESS BOARD'S (MAAB) REQUIREMENTS.
 - UNLESS OTHERWISE NOTED:
 - TYPICAL SIDEWALK/WALKWAY CROSS-SLOPE SHALL BE 1.0% MINIMUM, 2.0% MAXIMUM.
 - SIDEWALK/WALKWAY RUNNING SLOPE SHALL BE 1.0% MINIMUM, 5.0% MAXIMUM.
 - SLOPES SHALL NOT EXCEED 2% ACROSS ANY ACCESSIBLE PARKING SPACE AND ACCESS AISLES.
 - THE CONTRACTOR SHALL VERIFY ALL LAYOUT, DIMENSIONS, GRADES, AND INVERTS PRIOR TO CONSTRUCTION; REPORT ANY DISCREPANCIES TO BERKSHIRE DESIGN GROUP. ALL DISCREPANCIES SHALL BE RESOLVED IN WRITING PRIOR TO BEGINNING WORK.

- UTILITY NOTES**
- THE LOCATION, SIZE, AND TYPES OF ALL EXISTING UNDERGROUND UTILITIES SHOWN ARE APPROXIMATE. BERKSHIRE DESIGN GROUP DOES NOT WARRANT THE UTILITY INFORMATION DEPICTED. PRIOR TO THE START OF WORK, THE CONTRACTOR SHALL VERIFY THE LOCATION OF ALL UTILITIES AND CONTACT DIG SAFE AT 811.

E:\NORTHAMPTON - BOGGY MEADOW RD ADA TRAIL\03-DESIGN\PROCESSOR\DRAWINGS\LC-120 - LAYOUT & GRADING - BOGGY MEADOWS RD.DWG PLOT DATE: 10/27/2025

LC-121 A

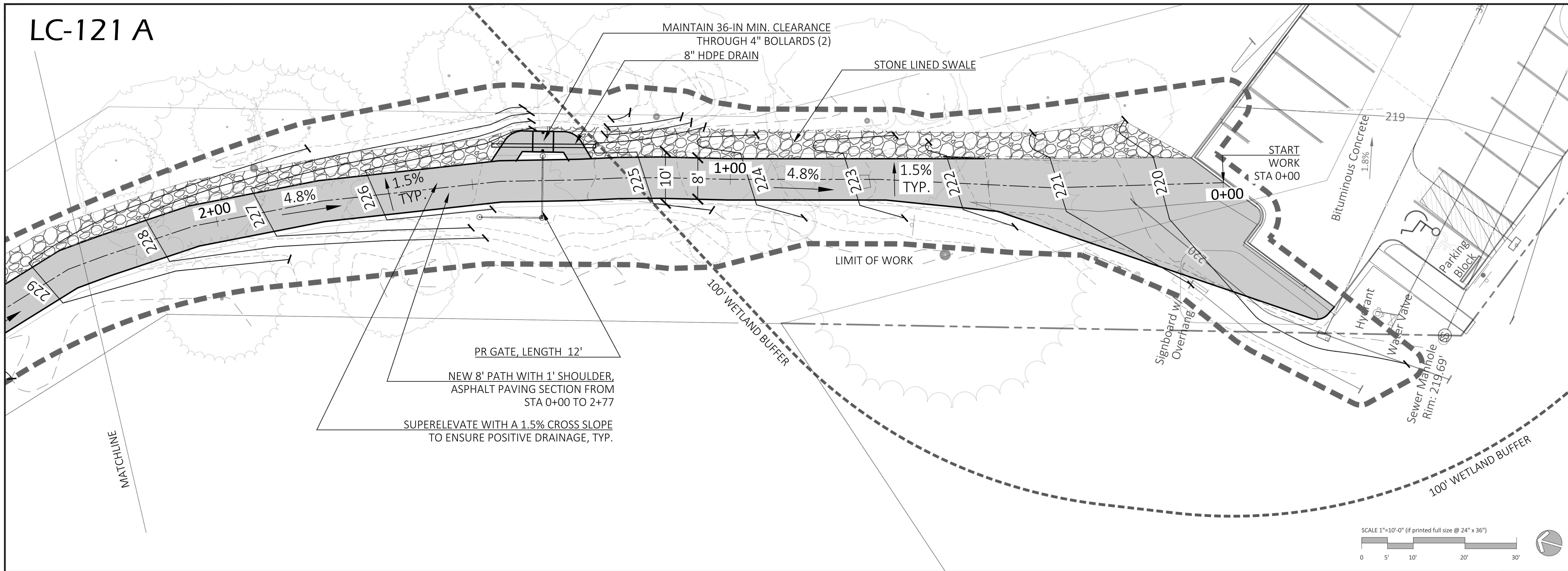

This drawing is not intended nor shall it be used for construction purposes unless the signed professional seal of a registered landscape architect, civil engineer or land surveyor employed by The Berkshire Design Group, Inc. is affixed above.
 Do not scale drawing for quantity take-offs or construction. Use written dimensions only. If dimensions are incomplete, contact The Berkshire Design Group Inc. for clarification.
 © Copyright The Berkshire Design Group, Inc.
 This drawing and all of its contents are instruments of service of The Berkshire Design Group, Inc. and shall not be copied or used in any way without the written consent of The Berkshire Design Group, Inc.

City of Northampton
 Boggy Meadow Road
 Accessible Trail
 Fitzgerald Lake
 Conservation Area

LC-121 B

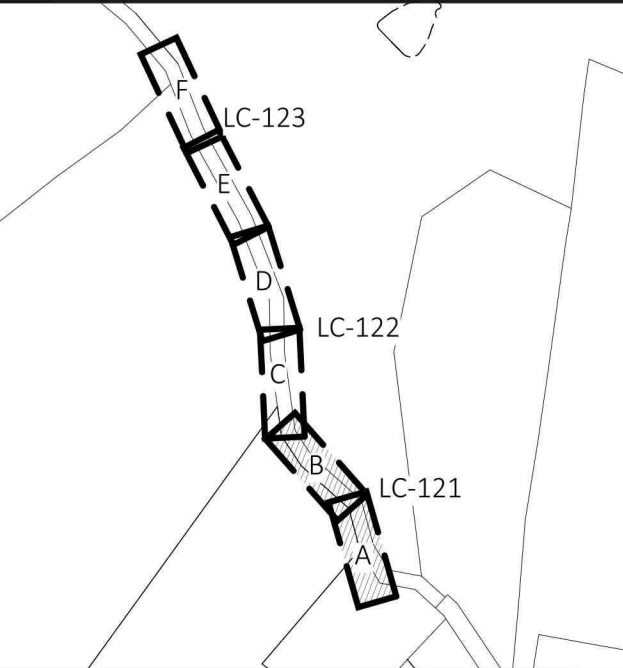
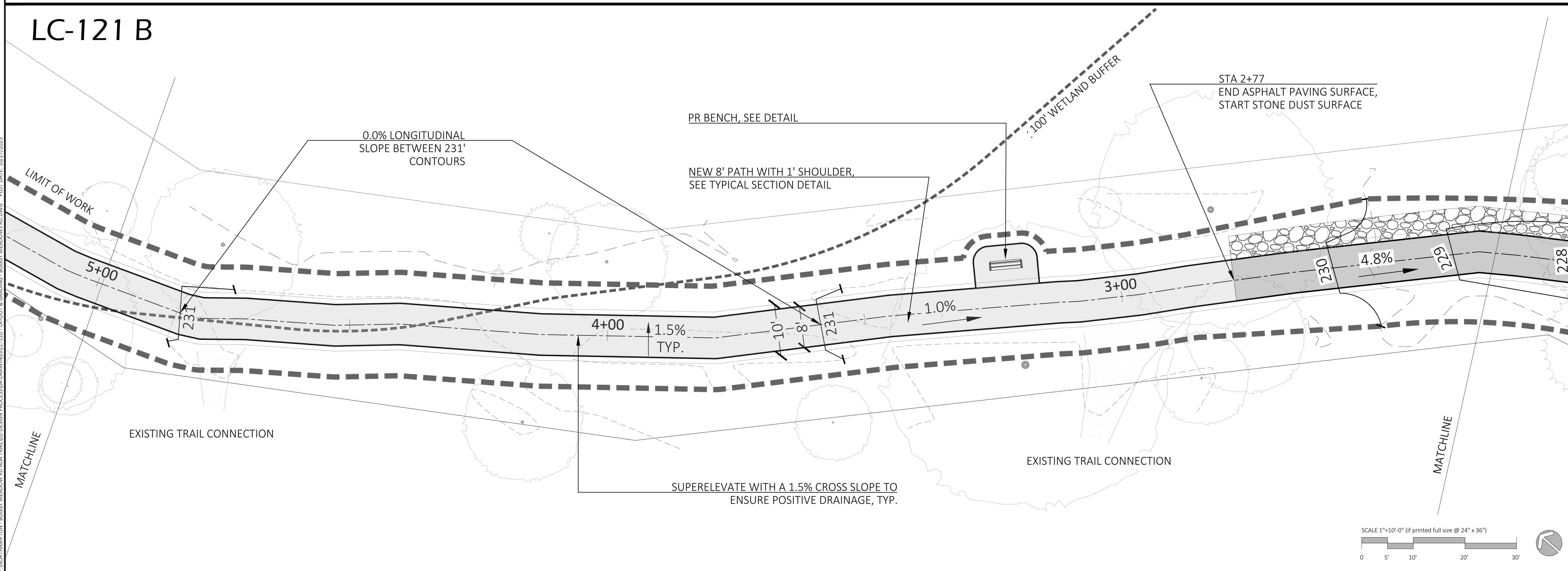

Site Grading & Drainage Plan

BID SET

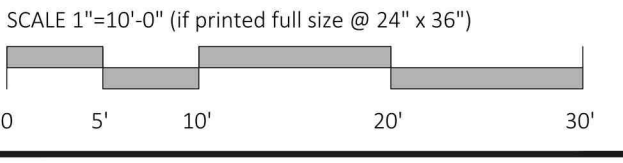

Revisions	

Date:	October 27, 2025	Sheet Number	LC-121
Scale:	1"=10'		
Drawn By:	MET		
Checked By:	CC		

E:\NORTHAMPTON - BOGGY MEADOW RD ADA TRAIL\LD-DESIGN\PROCESS\DRAWINGS\LC-121 - LAYOUT & GRADING - BOGGY MEADOWS RD.DWG - PLOT DATE: 10/27/2025

LC-122 C

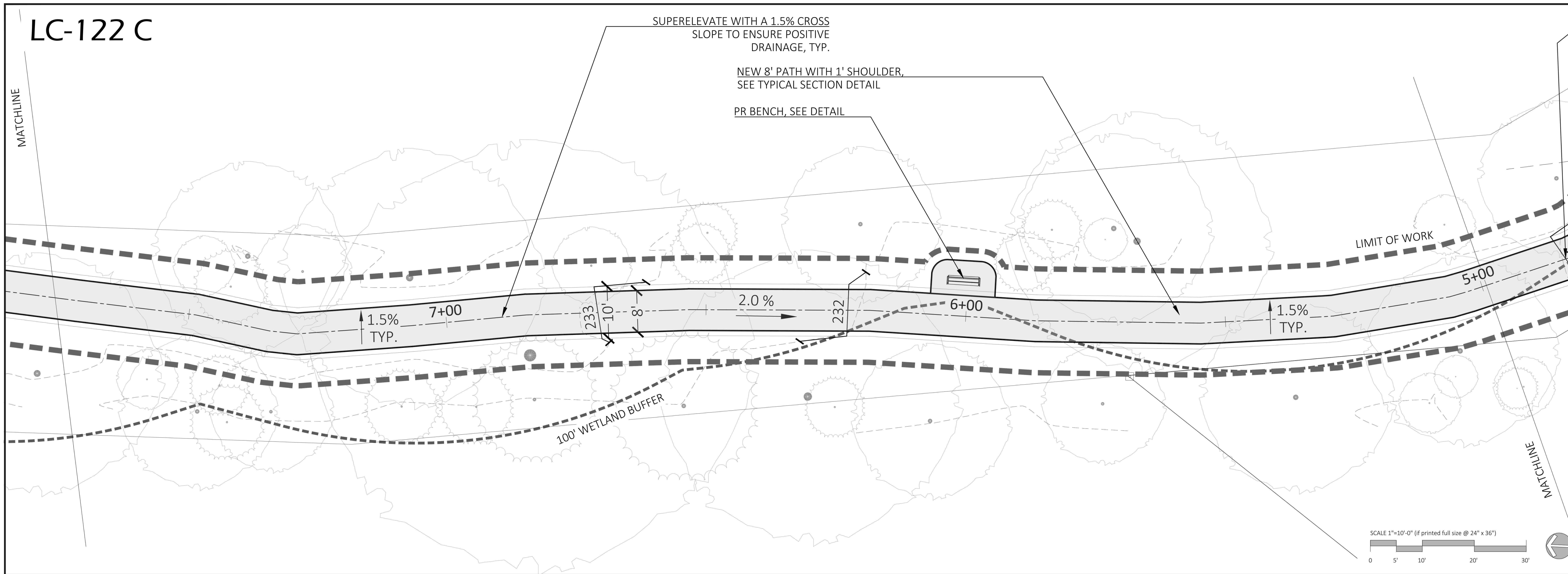

This drawing is not intended nor shall it be used for construction purposes unless the signed professional seal of a registered landscape architect, civil engineer or land surveyor employed by The Berkshire Design Group, Inc. is affixed above.
 Do not scale drawings for quantity take-offs or construction. Use written dimensions only. If dimensions are incomplete, contact The Berkshire Design Group, Inc. for clarification.
 © Copyright The Berkshire Design Group, Inc.
 This drawing and all of its contents are instruments of service of The Berkshire Design Group, Inc. and shall not be copied or used in any way without the written consent of The Berkshire Design Group, Inc.

City of Northampton
 Boggy Meadow Road
 Accessible Trail
 Fitzgerald Lake
 Conservation Area

LC-122 D

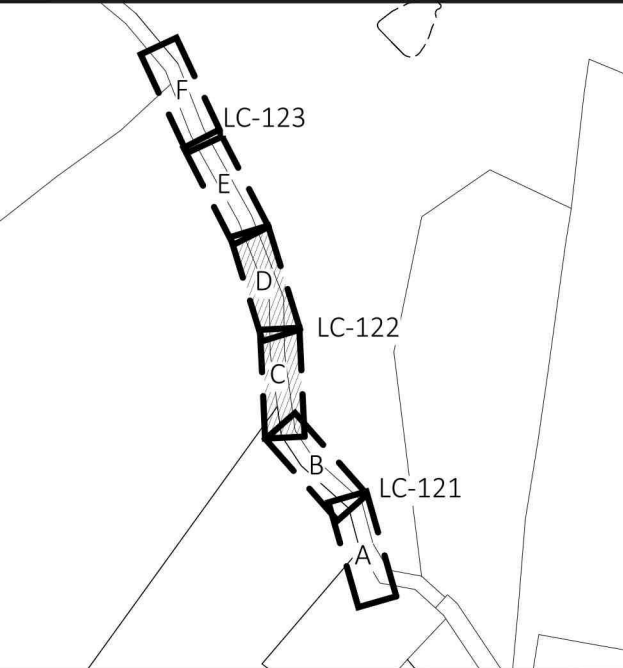
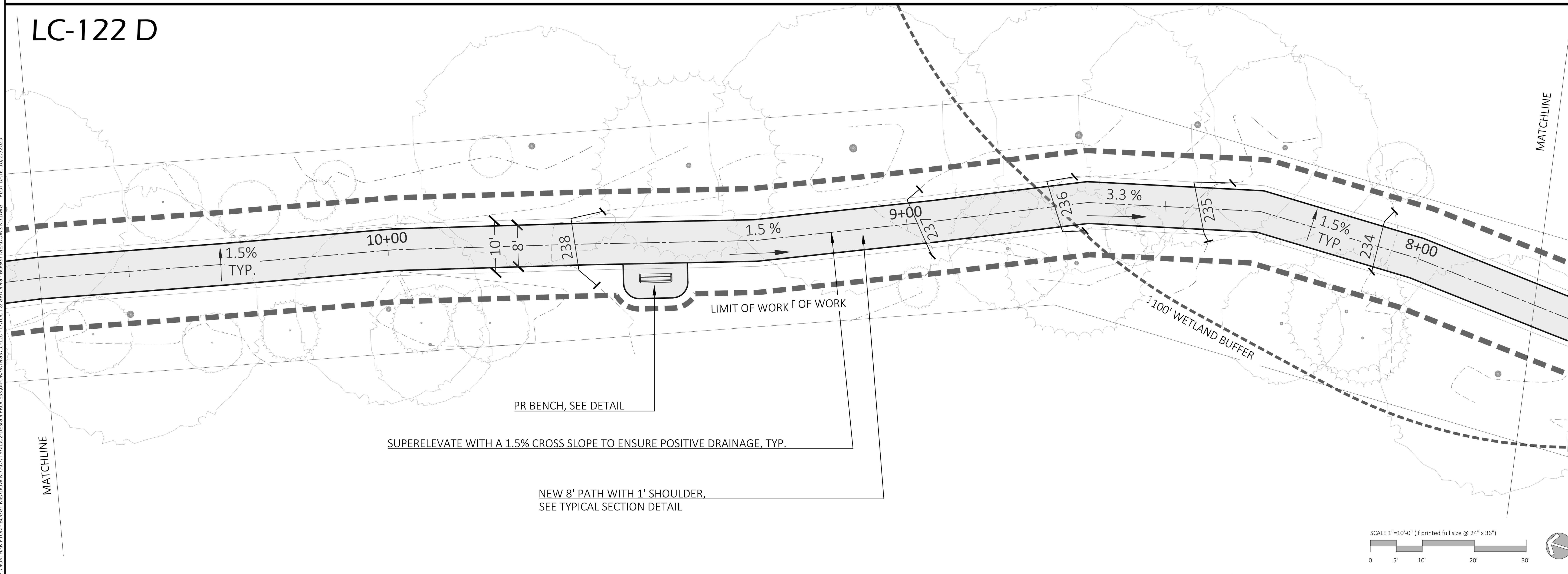

Site Grading &
 Drainage Plan
BID SET

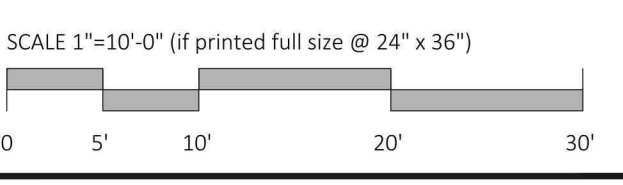

Revisions	

Date: October 27, 2025
 Scale: 1"=10'
 Drawn By: MET
 Checked By: CC
 Sheet Number: LC-122

E:\NORTHAMPTON - BOGGY MEADOW RD ADA TRAIL\LD DESIGN PROCESS\DRAWINGS\LC-122 - LAYOUT & GRADING - BOGGY MEADOWS RD.DWG - PLOT DATE: 10/27/2025

LC-123 E

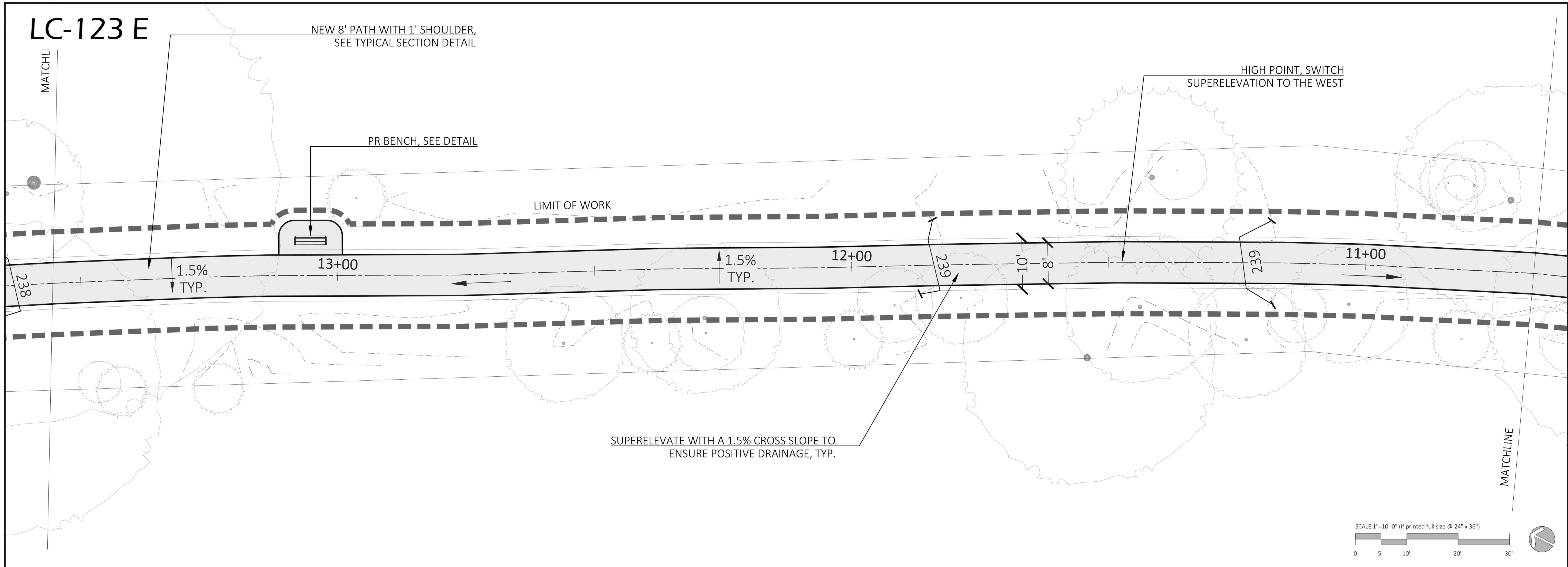

This drawing is not intended nor shall it be used for construction purposes unless the signed professional seal of a registered landscape architect, civil engineer or land surveyor employed by The Berkshire Design Group, Inc. is affixed above.
 Do not scale drawing for quantity take-offs or construction. Use written dimensions only. If dimensions are incomplete, contact The Berkshire Design Group Inc. for clarification.
 © Copyright The Berkshire Design Group, Inc. This drawing and all of its contents are instruments of service of The Berkshire Design Group, Inc. and shall not be copied or used in any way without the written consent of The Berkshire Design Group, Inc.

City of Northampton
 Boggy Meadow Road
 Accessible Trail
 Fitzgerald Lake
 Conservation Area

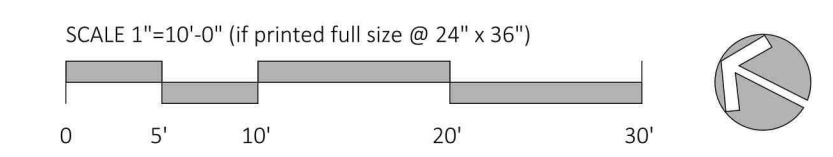

LC-123 F

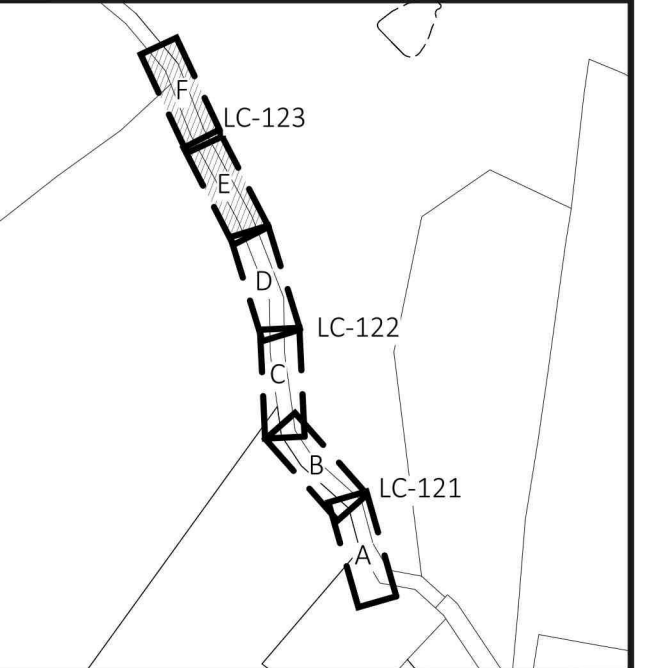
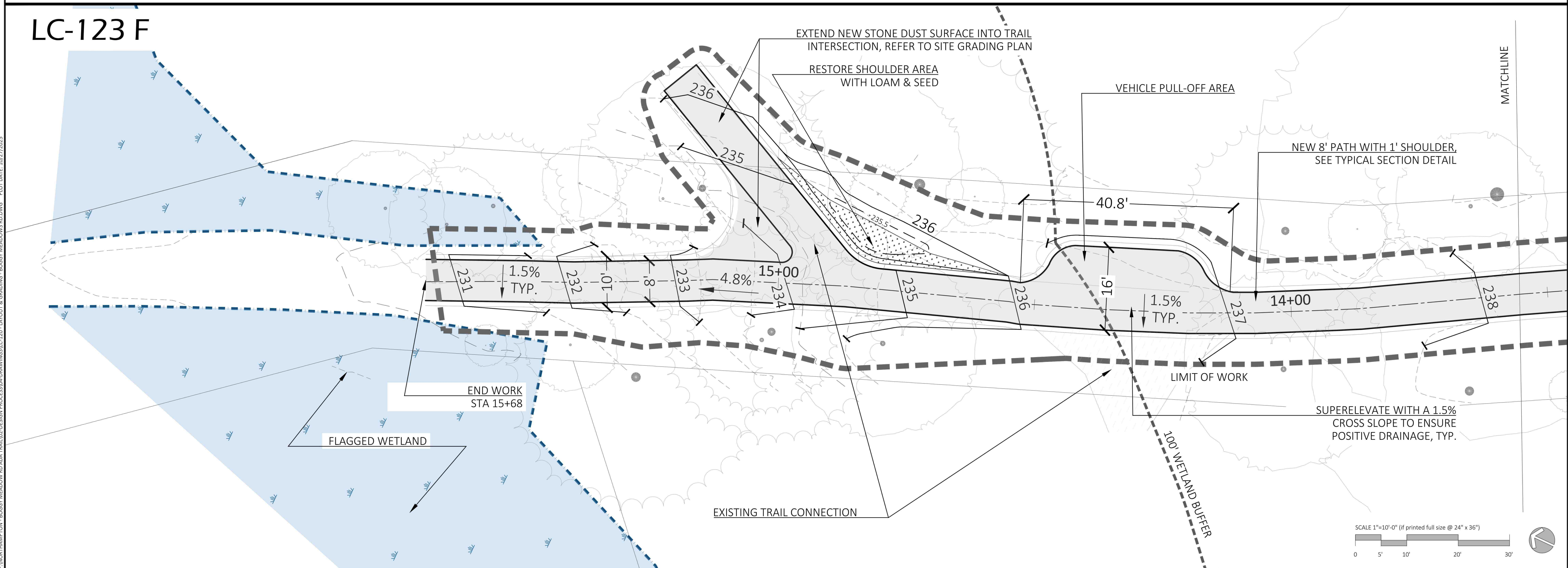

Site Grading & Drainage Plan

BID SET

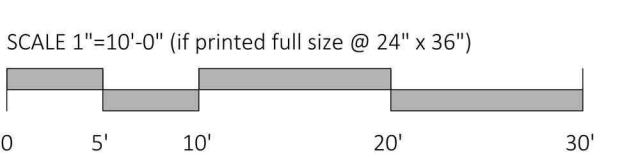

Revisions	

Date: October 27, 2025	Sheet Number
Scale: 1"=10'	LC-123
Drawn By: MET	
Checked By: CC	

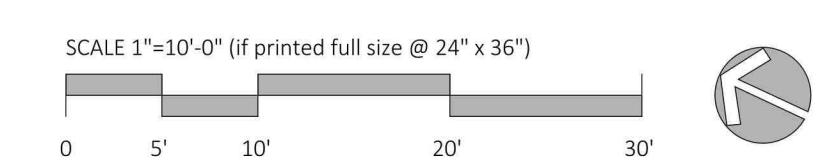

E:\NORTHAMPTON - BOGGY MEADOW RD ADA TRAIL\DESIGN PROCESS\DRAWINGS\LC-123 - LAYOUT & GRADING - BOGGY MEADOWS RD.DWG - PLOT DATE: 10/27/2025

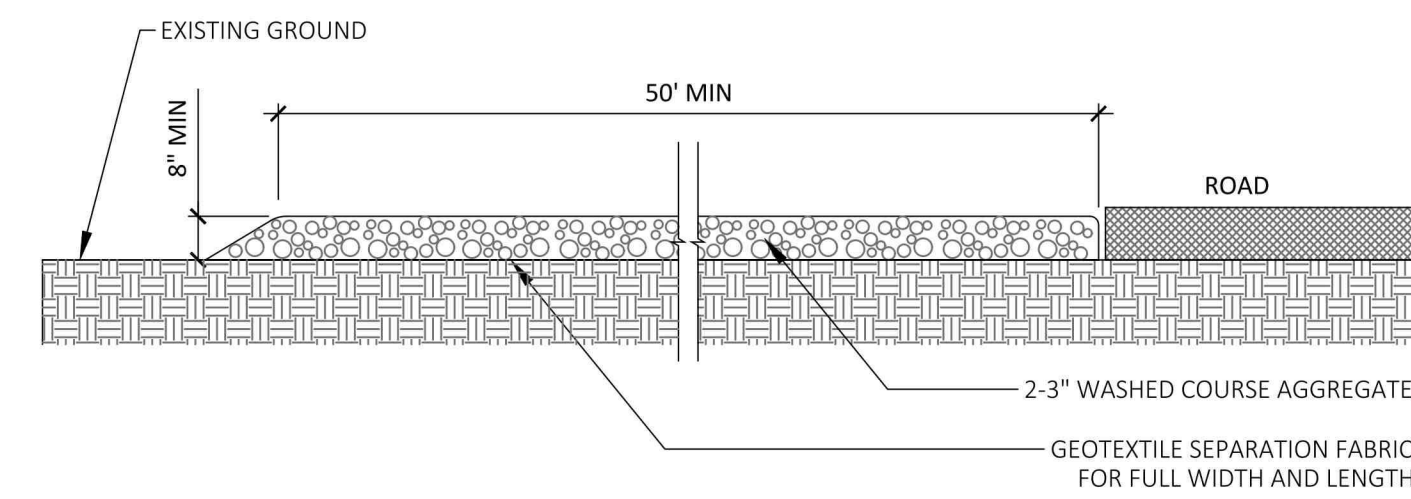

STABILIZED CONSTRUCTION ACCESS NOTES:

1. DIMENSIONS: WIDTH: 15' FLARED TO 25' AT ROADWAY LENGTH: 50' MIN. GRADE AND CROSS SLOPE: 2%
2. CLEAR ACCESS OF ALL VEGETATION, ROOTS, AND OTHER OBJECTIONABLE MATERIAL.
3. GRADE THE ROAD SUBGRADE SO THAT THE ACCESS WILL NOT DRAIN OFF SITE.
4. MAINTAIN THE GRAVEL PAD IN A CONDITION TO PREVENT MUD, SEDIMENT, ETC. FROM LEAVING THE SITE. SHOULD MUD/SEDIMENT BE TRACKED OR WASHED INTO THE PUBLIC ROAD IT SHALL BE REMOVED IMMEDIATELY.

01 STABILIZED CONSTRUCTION ENTRANCE

SCALE: NTS

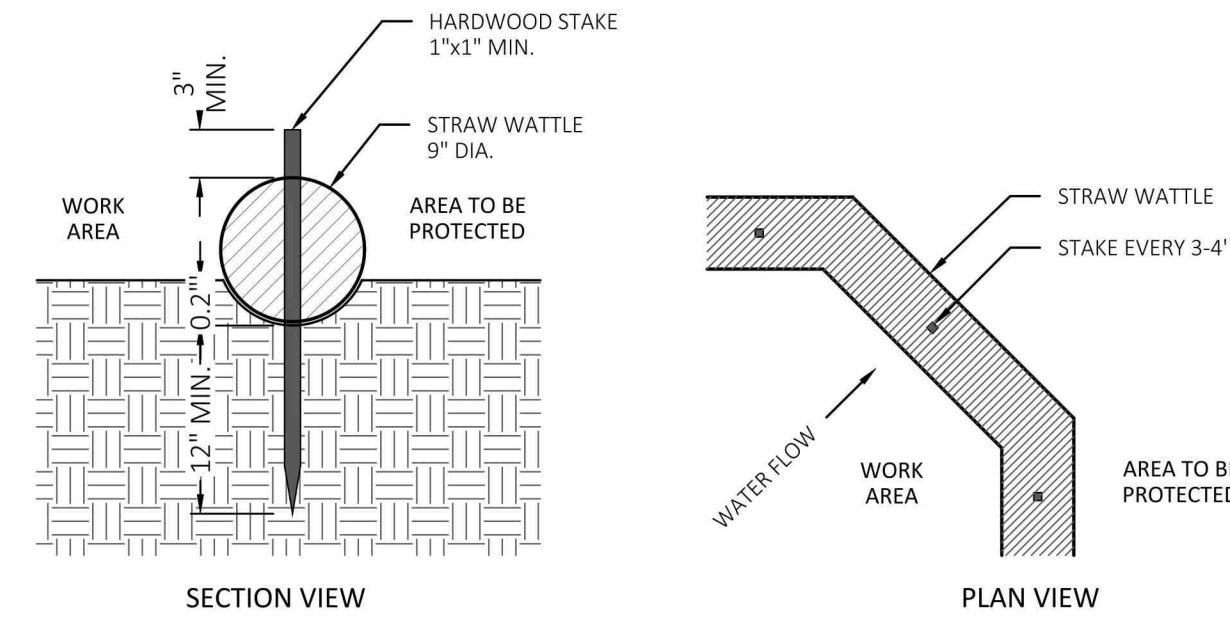

NOTES

1. WATTLE CASING SHALL BE HDPE, BURLAP FIBER, OR JUTE NETTING.
2. STRAW FILLING SHALL BE THRESHED AND FREE FROM SEEDS.
3. NETTING AND STAKES SHALL BE COMPLETELY REMOVED FROM THE SITE PRIOR TO THE COMPLETION OF WORK.
4. STRAW MAY BE SPREAD ON SITE UNLESS OTHERWISE DIRECTED BY THE OWNER OR BERKSHIRE DESIGN GROUP AND SHALL BE SPREAD SO AS NOT TO INTERRUPT DRAINAGE PATHS.
5. AFTER REMOVAL OF EROSION CONTROLS, THE CONTRACTOR SHALL RAKE, LOAM, AND SEED REMAINING DISTURBED AREAS.

02 STRAW WATTLE - EROSION CONTROL

SCALE: NTS

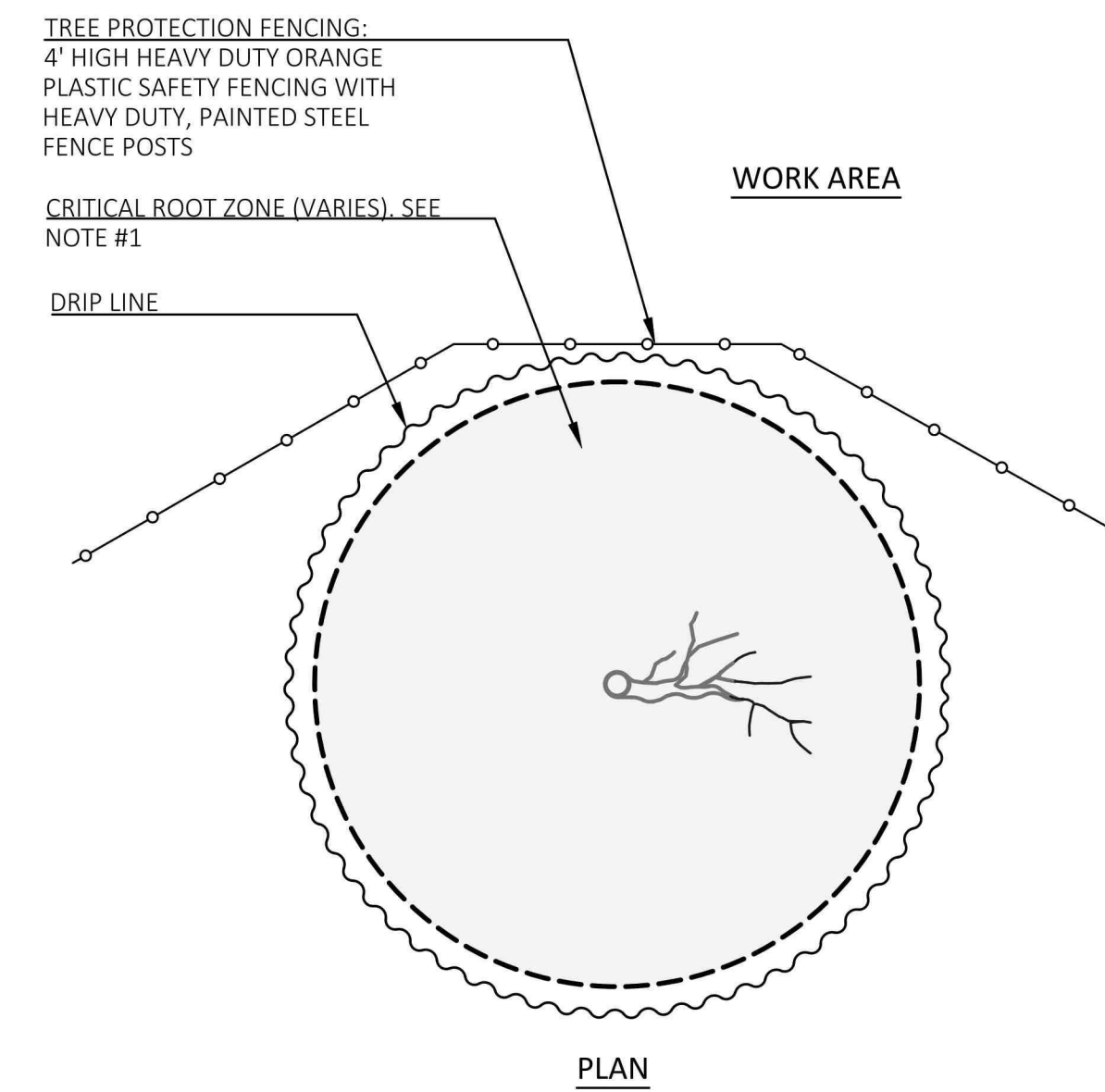

NOTES:

- 1) TREE PROTECTION FENCE LAYOUT SHALL BE FIELD FIT BY THE CONTRACTOR TO EXCEED BOTH THE CRITICAL ROOT ZONE AND DRIP LINE FOR EACH PROTECTED TREE.
- 2) THE CONTRACTOR SHALL INSTALL TREE PROTECTION FENCING PRIOR TO SITE WORK, AND REMOVE ON COMPLETION.
- 3) THE CONTRACTOR SHALL SCHEDULE A SITE VISIT WITH REQUIRED CITY REPRESENTATIVES TO VERIFY THE STATUS OF ALL TREES AND PROPOSED PROTECTION FENCING BEFORE DEMOLITION OR CONSTRUCTION ACTIVITIES BEGIN.
- 4) DBH IDENTIFIED BY ARBORISTS, AND CRITICAL ROOT ZONES ARE SHOWN ON THE PLAN.

03 TEMPORARY TREE PROTECTION - FOREST CONDITIONS

SCALE: NTS

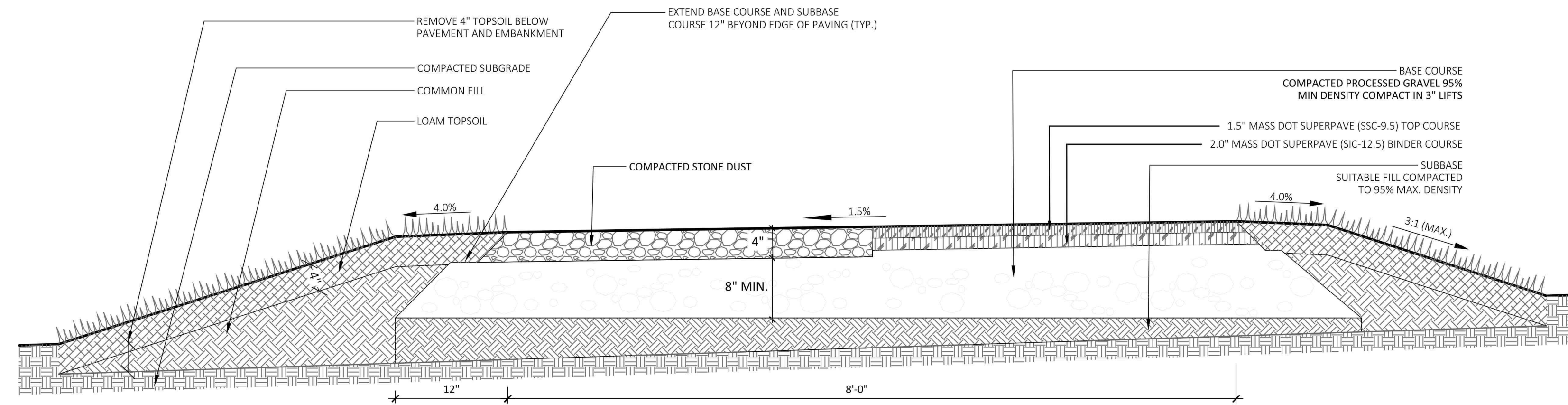

NOTES

1. ALL MATERIALS SHALL COMPLY WITH THE MASSDOT STANDARD SPECIFICATIONS FOR HIGHWAYS AND BRIDGES (CURRENT EDITION).
2. CONTRACTOR MAY REUSE THE EXISTING ROADWAY BASE MATERIAL SUBJECT TO APPROVAL BY THE ENGINEER. PRIOR TO REUSE, THE CONTRACTOR SHALL PERFORM TEST PITS AT A RATE OF 1 PER 500 LINEAR FEET TO DETERMINE DEPTH OF MATERIAL AND PERFORM LABORATORY TESTING TO CONFIRM THE EXISTING BASE MATERIAL MEETS THE SPECIFICATIONS.
3. GRAVEL BASE COURSE SHALL BE PLACED IN EQUAL 6\"/>

04 TYPICAL STONE DUST OR ASPHALT PAVING

SCALE: NTS

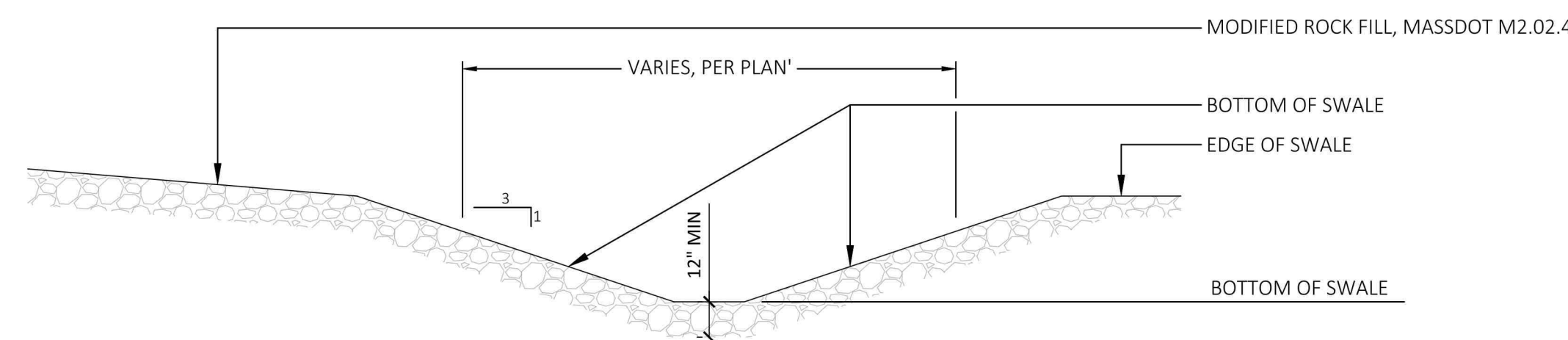

05 STONE LINED SWALE

SCALE: NOT TO SCALE

This drawing is not intended nor shall it be used for construction purposes unless the signed professional seal of a registered landscape architect, civil engineer or land surveyor employed by The Berkshire Design Group, Inc. is affixed above.
Do not scale drawing for quantity take-offs or construction. Use written dimensions only. If dimensions are incomplete, contact The Berkshire Design Group Inc. for clarification.
© Copyright The Berkshire Design Group, Inc.
This drawing and all of its contents are instruments of service of The Berkshire Design Group, Inc. and shall not be copied or used in any way without the written consent of The Berkshire Design Group, Inc.

City of Northampton
Boggy Meadow Road
Accessible Trail
Fitzgerald Lake
Conservation Area

Site Details

BID SET

Revisions

NO.	DATE	DESCRIPTION

Date: October 27, 2025	Sheet Number
Scale: NTS	LC-501
Drawn By: MET	
Checked By: CC	

